



### 32 Elimatta Avenue JORDAN SPRINGS NSW

3  2  1 

Spanning over an extensive single level design, this beautifully constructed residence presents a practical layout with executive finishes, multiple living zones and an established backyard that is perfect for effortless entertaining. It is located within a highly sought-after pocket of Jordan Springs Estate, and is close to Jordan Springs Shopping Centre, public transport, Jordan Springs Public School and scenic walking tracks/parkland.

- Near new family home with multiple lounge/dining zones
- All-weather alfresco overlooks the child-friendly backyard
- Stone kitchen equipped with stainless steel gas appliances
- Three good-sized bedrooms are fitted with built-in robes
- Well presented main bathroom, ensuite to the master

**Type** : House  
**Land Size** : 300 sqm  
**View** : <https://www.aitkenre.com.au/8063828>

[For full version visit the website](https://www.aitkenre.com.au)



DISCLAIMER: All dimensions herein are approximate and gathered from sources believed to be reliable. Whilst every effort is made for the accuracy of our plans, interested parties should rely on their own enquiries.

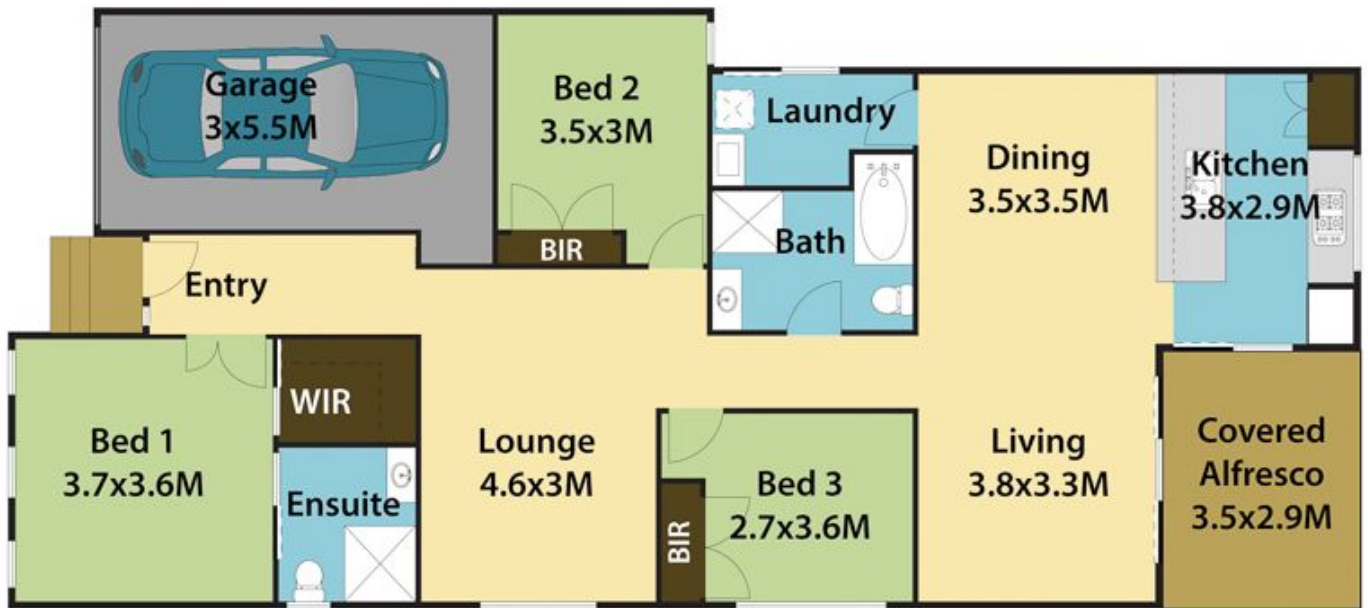

32 Elimatta Ave, Jordan Springs.

