



5/31 Adelaide Street OXLEY PARK NSW

4 🛏 2 🚿 2 🚗

5/31 Adelaide Street, Oxley Park
 Brand new townhouse set in a convenient location
 Brand new, tastefully appointed and conveniently located,
 this modern townhouse creates a stylish, low
 maintenance lifestyle wonderfully suited to a growing family
 or an astute investor.

Type : Townhouse
View : <https://www.aitkenre.com.au/8063813>

It's set within well-maintained complex just moments from
 bus stops, parks and train stations.

- Traditional dual-level design with spacious lounge/dining zone
- Sliding doors extend to a landscaped, child-friendly backyard
- Caesarstone benchtop kitchen is equipped with stainless steel gas appliances
- Four good-sized bedrooms are each fitted with built-in

[For full version visit the website](https://www.aitkenre.com.au)

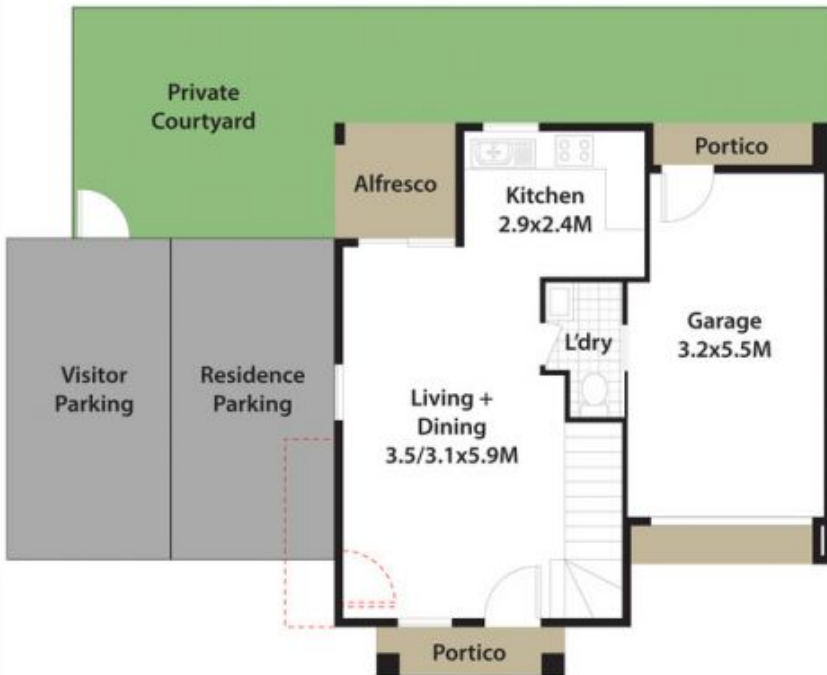

Units 2 + 4 Shown
Units 3 + 5 Mirrored
Unit 1 Portico + Front Door in Red



31 Adelaide St, Oxley Park.

DISCLAIMER: All dimensions herein are approximate and gathered from sources believed to be reliable. Whilst every effort is made for the accuracy of our plans, interested parties should rely on their own enquiries.

