



36/324 Woodstock Avenue MOUNT DRUITT NSW

2 1 1

Recently renovated to offer a stylish yet easy care lifestyle, this private apartment enjoys a spacious open concept design and an elevated leafy outlook. It's currently tenanted with a long term lease and is conveniently located within a short distance to Westfield, public transport and eateries.

Type : Apartment

View : <https://www.aitkenre.com.au/8063811>

- Currently leased out at \$400.00 per week to fantastic tenants
- Spacious open floor plan offers large living and dining zones
- Engineered European oak flooring throughout
- Interiors extend out to a relaxed all-weather balcony
- Recently updated kitchen with steel gas appliances and a walk-in pantry
- Two large bedrooms are fitted with built-in wardrobes

[For full version visit the website](#)

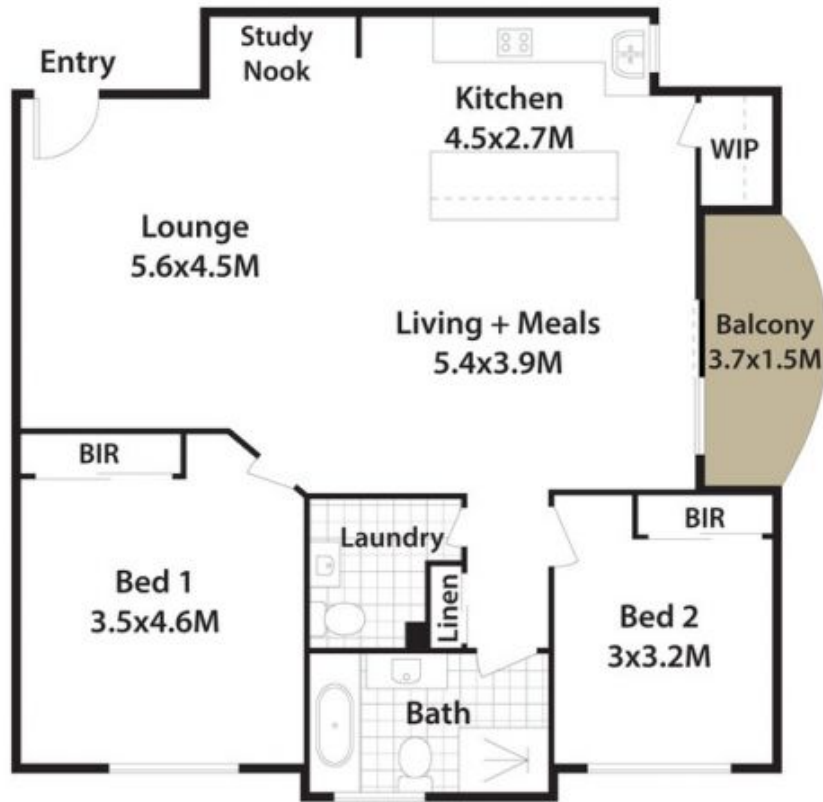

Allocated
Lockup
Garage

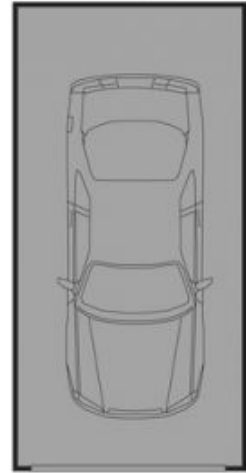

36/324 Woodstock Ave, Mt Druitt.

DISCLAIMER: All dimensions herein are approximate and gathered from sources believed to be reliable. Whilst every effort is made for the accuracy of our plans, interested parties should rely on their own enquiries.

