



7 Gumara Street SILVERDALE NSW

4  2  3 

Newly constructed by Beechwood in the prestigious Cascades Estate, sits this wonderful 4 bedroom family home. The home boasts a versatile floor plan offering 4 spacious bedrooms, all with built in's and main with walk in robe and open ensuite.

Type : House
Land Size : 700 sqm
View : <https://www.aitkenre.com.au/8063766>

All situated on a level 700sqm with plenty of side access, perfect for a large shed or pool to escape the summer heat! Under the main roof, the home offers spacious triple garage with additional single car drive through.



Aimee Mitchell
02 4773 9511

[For full version visit the website](https://www.aitkenre.com.au)

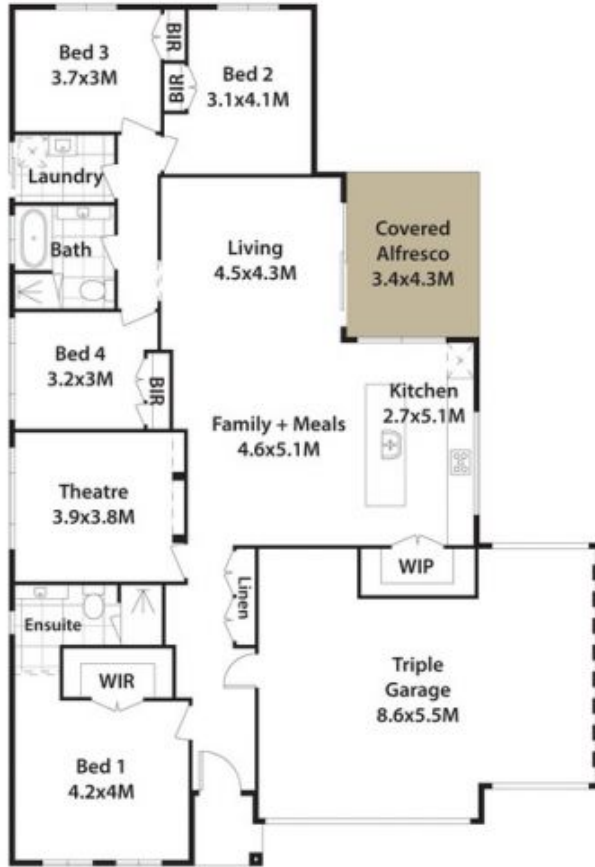

7 Gumara St, Silverdale.

DISCALIMER: All dimensions herein are approximate and gathered from sources believed to be reliable. Whilst every effort is made for the accuracy of our plans, interested parties should rely on their own enquiries.

