



34 Marsh Road SILVERDALE NSW

3  2  2 

Freshly modernised including carpet and painting this 3 bedroom home is sure to impress owners and investors alike.

Features include:

- 3 bedrooms all with built in robes
- Main with ensuite
- Meals area off well appointed kitchen with large breakfast bar
- L-shaped lounge and dining area
- Sunlit rear family room
- 3 way bathroom
- Slow combustion fire
- Large 1010sqm block
- Double garage with internal access
- Side access

Type : House

Land Size : 1010 sqm

View : <https://www.aitkenre.com.au/8063719>

[For full version visit the website](https://www.aitkenre.com.au)



DISCLAIMER: All dimensions herein are approximate and gathered from sources believed to be reliable. Whilst every effort is made for the accuracy of our plans, interested parties should rely on their own enquiries.

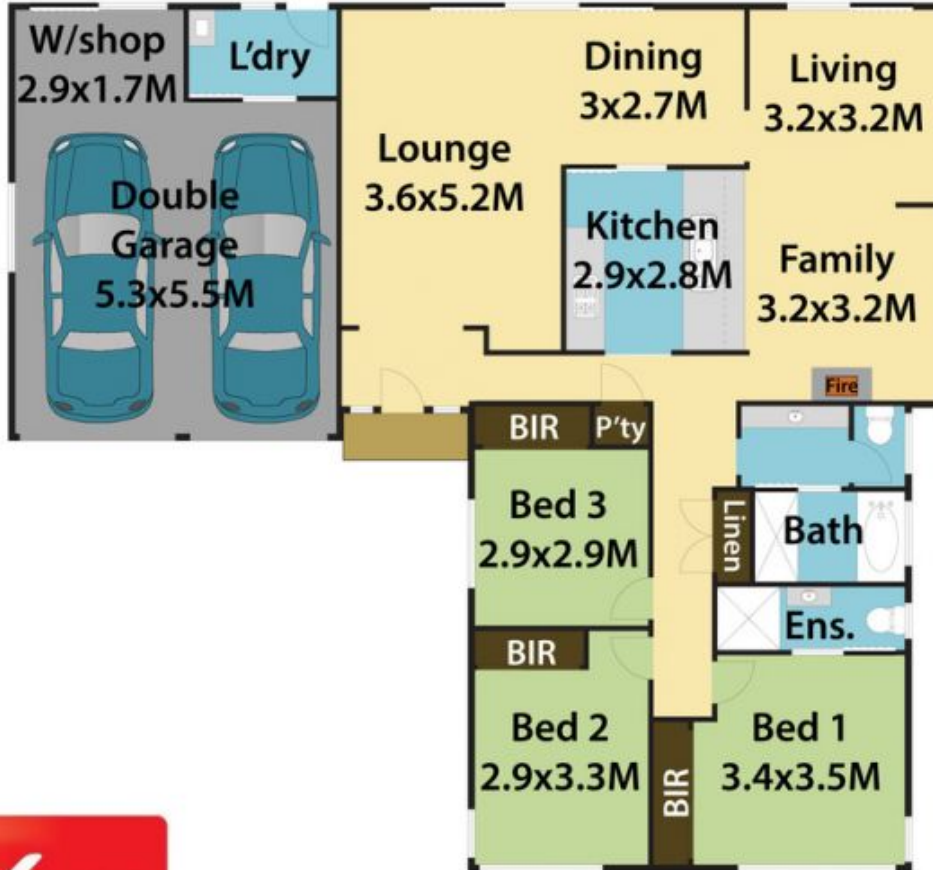

34 Marsh Rd, Silverdale.