



**7b Matthews Street Emu Heights NSW**

4  2  4 

Enter a world of grandeur and indulge in this contemporary architecturally designed home. Immerse yourself in a harmonious blend of sophistication and functionality, with high-end finishes that redefine modern living. The innovative design allows you to customise your living space to suit your family's evolving needs. Whether you're expanding your family or simply seeking a change, this floor plan can easily accommodate it all.

- + Enjoy tastefully designed spaces with soaring ceilings and a modern colour palette, creating the perfect backdrop for contemporary living.
- + Provision for multiple living spaces provide ample room to accommodate various aspects of your lifestyle, ensuring comfort and convenience.

**Type** : House  
**Price** : \$ 1,230,000  
**View** : <https://www.aitkenre.com.au/8063493>



**Connor Walker**  
**02 4733 6999**

[For full version visit the website](https://www.aitkenre.com.au)

Ground floor  
134.2 sq.m. approx.

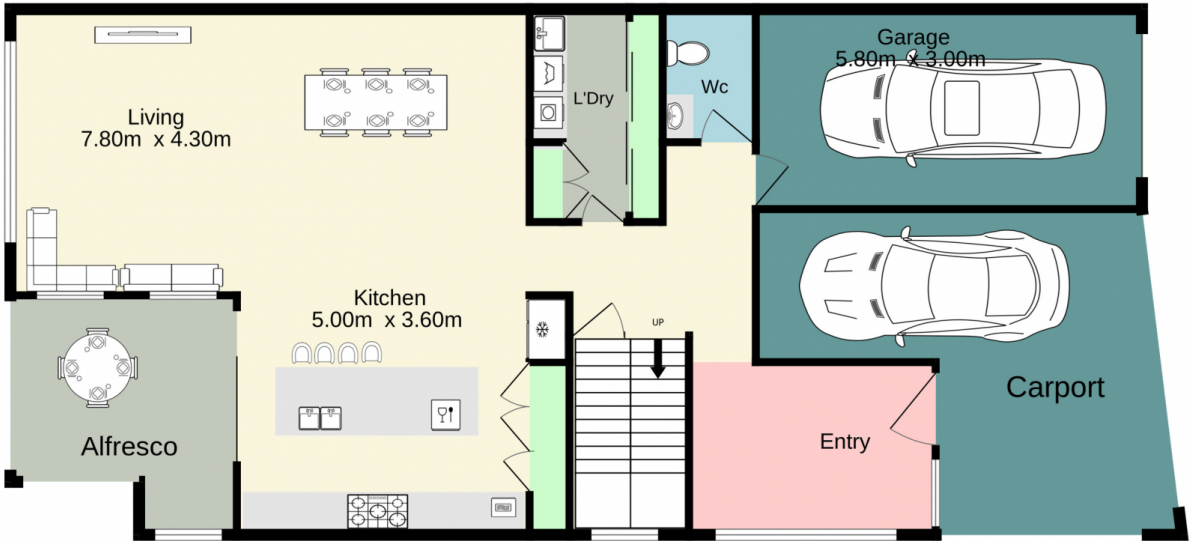

1st floor  
114.7 sq.m. approx.

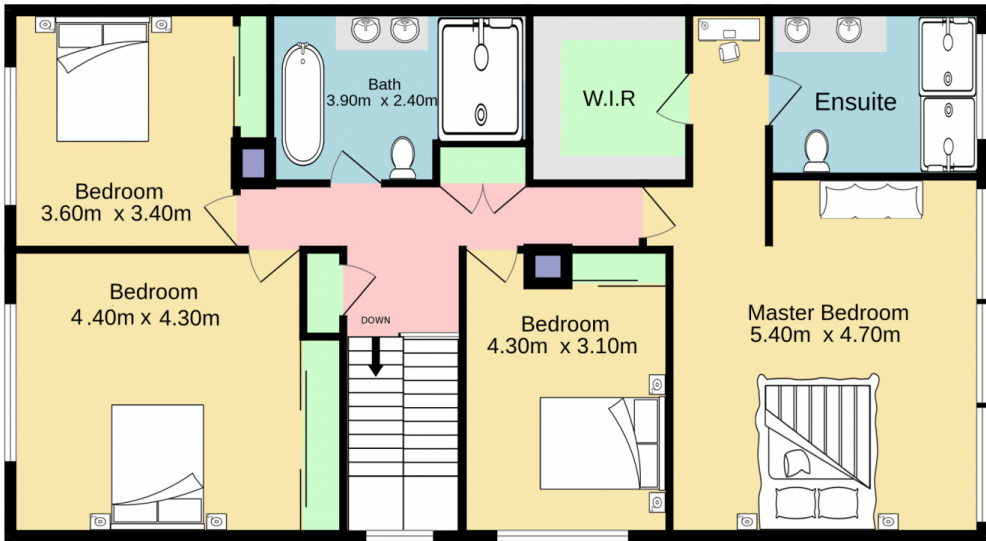

TOTAL FLOOR AREA : 248.9 sq.m. approx.

Whilst every attempt has been made to ensure the accuracy of the floorplan contained here, measurements of doors, windows, rooms and any other items are approximate and no responsibility is taken for any error, omission or mis-statement. This plan is for illustrative purposes only and should be used as such by any prospective purchaser. The services, systems and appliances shown have not been tested and no guarantee as to their operability or efficiency can be given.  
Made with Metropix ©2023