





## 6 Curlew Court Glenmore Park NSW

4  2  4 

Few single level properties can offer such a tranquil, spacious, and lovingly ambiance as this splendour home. Perched on the high side of a quiet, tree-lined cul-de-sac, the home offers multiple living areas, an open plan kitchen, four large bedrooms and is within close proximity to all local amenities and main roads. You will be impressed by the indoor and outdoor flow to the entertaining area and backyard. The generous outdoor alfresco area allows plenty of room to entertain guests or hold family gatherings overlooking the large low maintenance backyard, there is room for the kids, pets, pool, and the entire family. your new home will be the central hub for family and friends.

- + Large 675sqm block (approx)
- + Open plan kitchen with island bench, gas cooking and

[For full version visit the website](https://www.aitkenre.com.au)

**Type** : House  
**Price** : \$ 1,235,000  
**Land Size** : 675 sqm  
**View** : <https://www.aitkenre.com.au/8063433>



**Diego Benitez**  
**02 4733 6999**

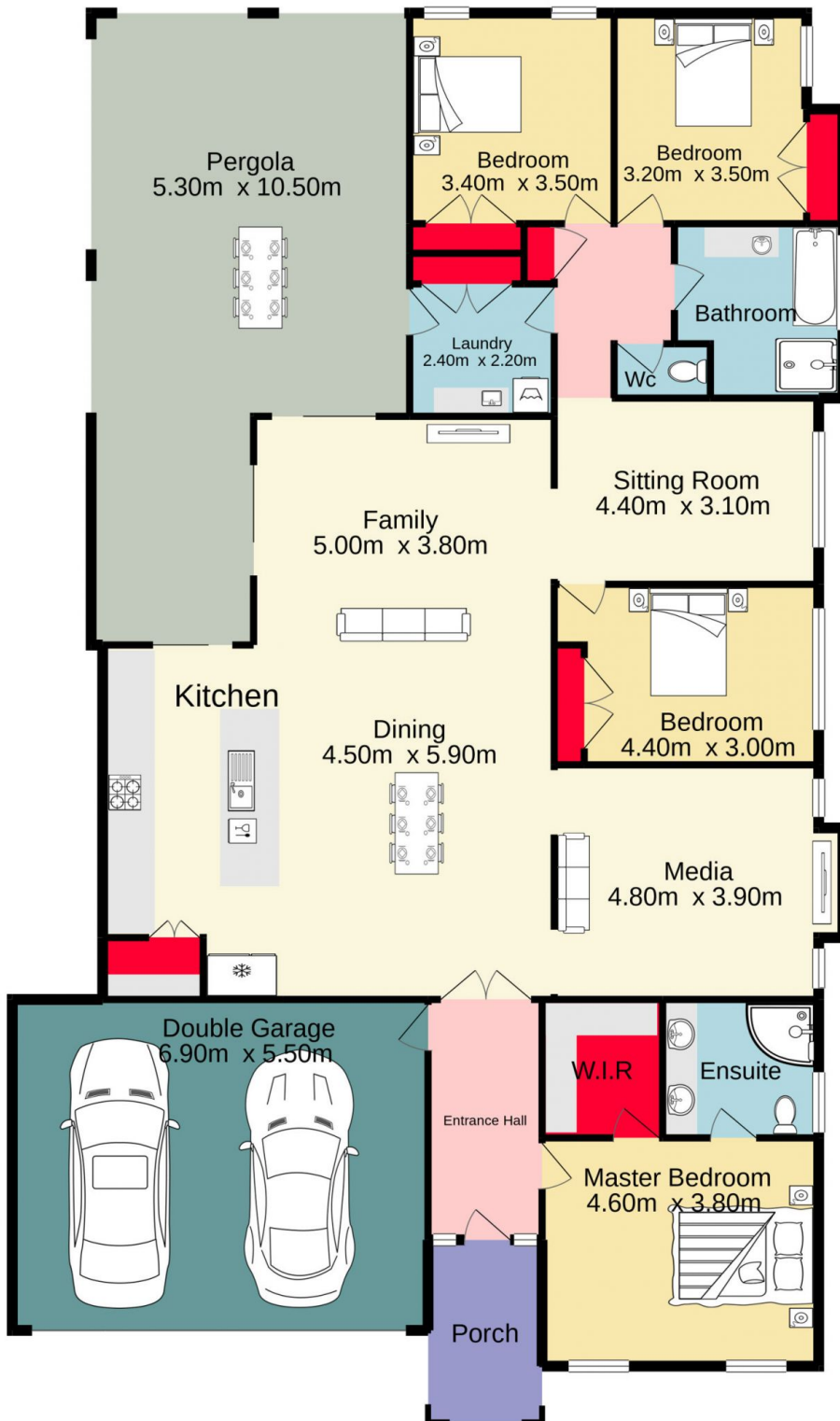

 **Jim Aitken**  
Partners

Whilst every attempt has been made to ensure the accuracy of the floorplan contained here, measurements of doors, windows, rooms and any other items are approximate and no responsibility is taken for any error, omission or mis-statement. This plan is for illustrative purposes only and should be used as such by any prospective purchaser. The services, systems and appliances shown have not been tested and no guarantee as to their operability or efficiency can be given.  
Made with Metropix ©2021