



### 34 Midin Close Glenmore Park NSW

3 2 2

Position perfect, quiet location, close to schools, buses and shops, this three bedroom east facing is one not to miss. Whether you are an investor, first home buyer or downsizer this property is the perfect fit. Featuring a free flowing floor plan and all amenities close at hand, with rear yard, on the high side of the street and a single car lock up garage.

<b>Type</b>	: House
<b>Price</b>	: \$ 800,000
<b>Building Size</b>	: 114 sqm
<b>Land Size</b>	: 376 sqm
<b>View</b>	: <a href="https://www.aitkenre.com.au/8063430">https://www.aitkenre.com.au/8063430</a>

- + Separate dining and living areas
- + Sizeable bedrooms with ceiling fans. Built in robes
- + Ensuite to main bedroom
- + Tiled and carpet throughout
- + Single lock up garage with internal access
- + Gas cooking with range hood
- + Family friendly backyard
- + Choice of 3 schools within 500m, 5 schools within 1

[For full version visit the website](https://www.aitkenre.com.au)

Ground floor  
110.3 sq.m. approx.

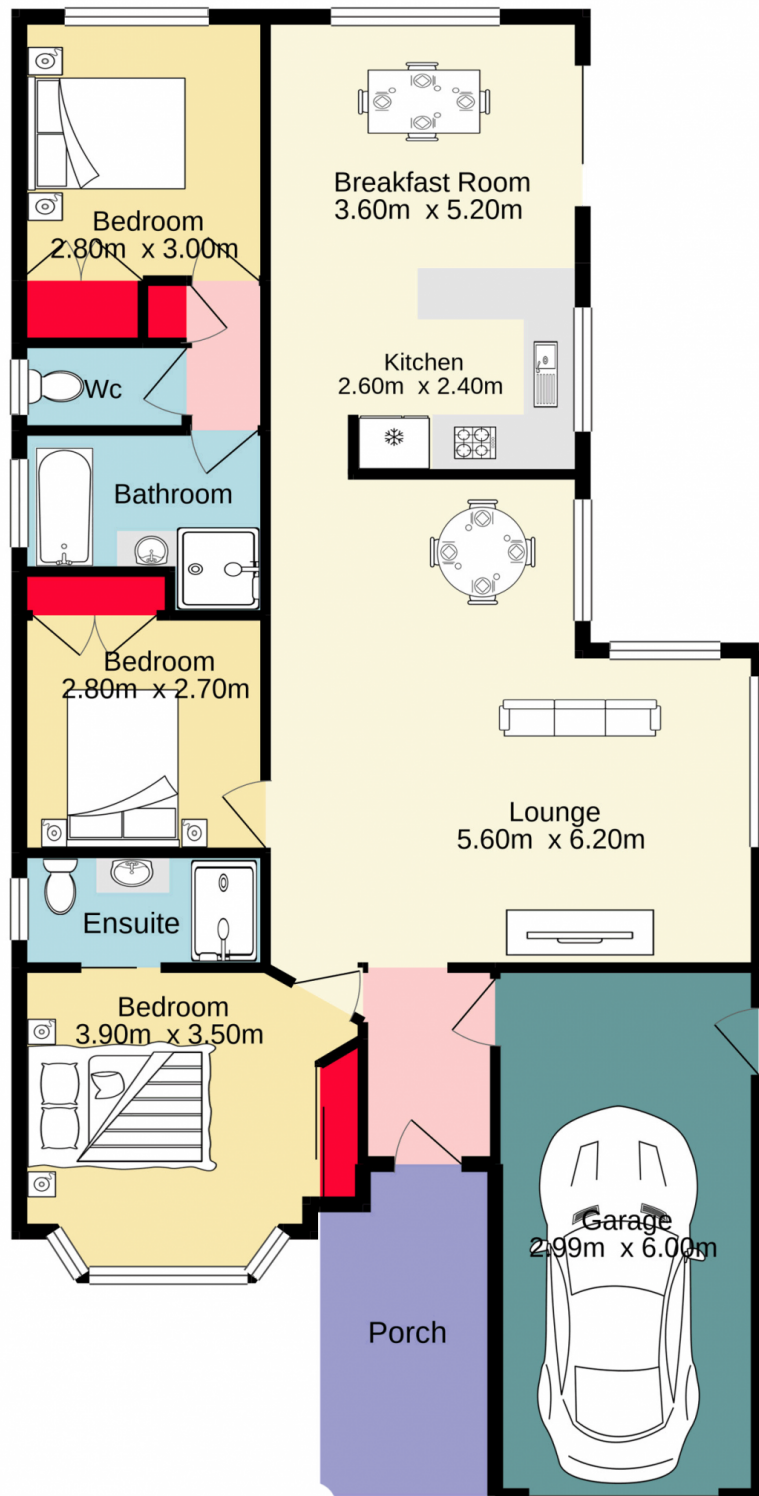

**Jim Aitken**  
+  
**Partners**



TOTAL FLOOR AREA : 110.3 sq.m. approx.

Whilst every attempt has been made to ensure the accuracy of the floorplan contained here, measurements of doors, windows, rooms and any other items are approximate and no responsibility is taken for any error, omission or mis-statement. This plan is for illustrative purposes only and should be used as such by any prospective purchaser. The services, systems and appliances shown have not been tested and no guarantee as to their operability or efficiency can be given.  
Made with Metropix ©2021