



## 22 Sittella Place Glenmore Park NSW

3  1  4 

Positioned perfect in a quiet location, close to schools, buses and shops. This large three bedroom, northwest facing home is a must for first home buyers and investors. Featuring a free flowing floor plan and all amenities close at hand, with rear yard, outdoor living area and a two car garage.

- + Separate dining and living areas
- + Sizeable bedrooms with built in robes
- + Tiled and carpet throughout
- + Double lock up garage with internal access
- + Access to the yard through the garage
- + Family friendly backyard with outdoor entertaining area
- + Choice of three schools within 500m

**Type** : House  
**Price** : \$ 780,000  
**Land Size** : 450 sqm  
**View** : <https://www.aitkenre.com.au/8063412>



**Diego Benitez**  
 02 4733 6999

[For full version visit the website](https://www.aitkenre.com.au)

# Ground floor

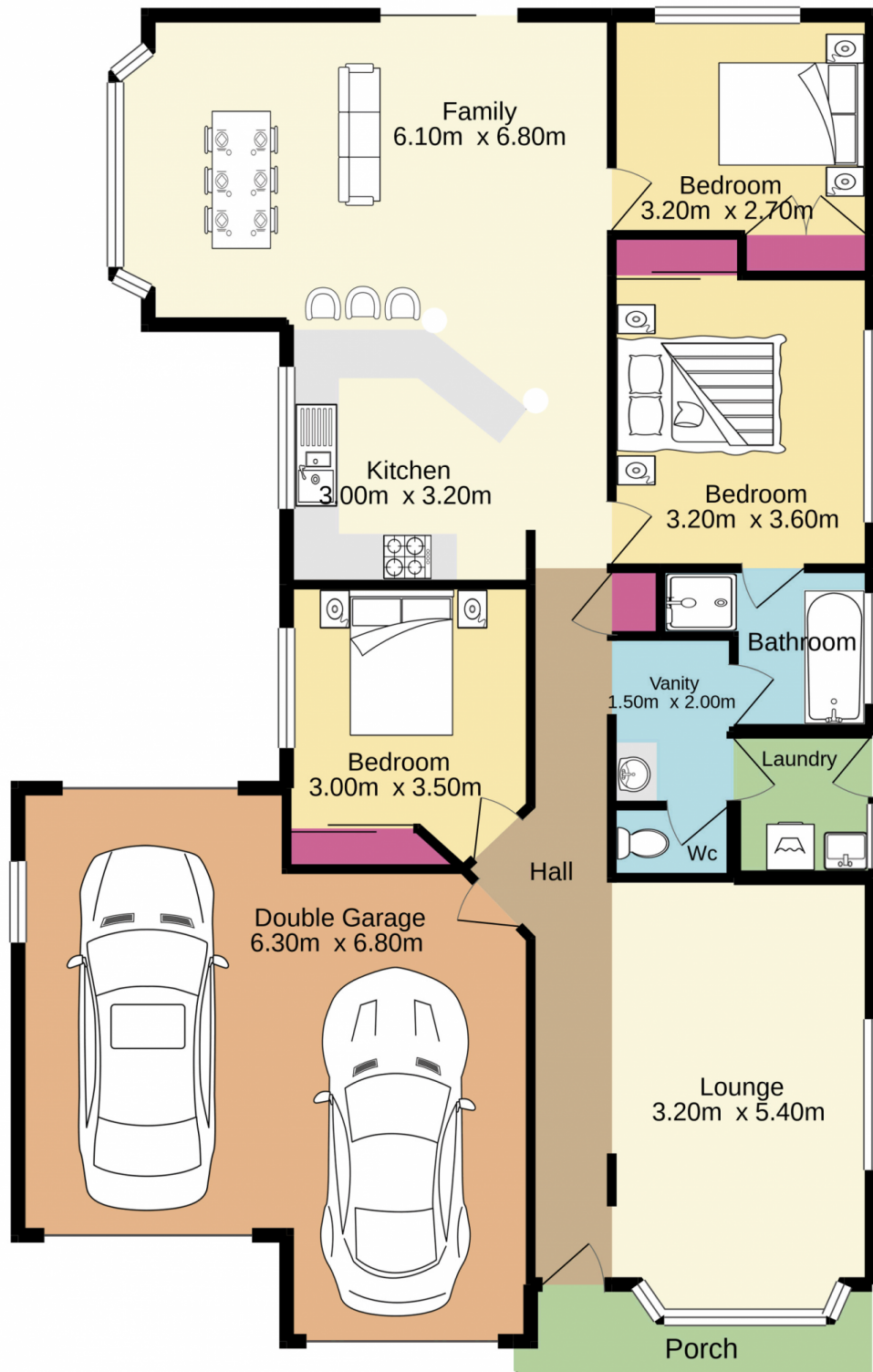

Whilst every attempt has been made to ensure the accuracy of the floorplan contained here, measurements of doors, windows, rooms and any other items are approximate and no responsibility is taken for any error, omission or mis-statement. This plan is for illustrative purposes only and should be used as such by any prospective purchaser. The services, systems and appliances shown have not been tested and no guarantee as to their operability or efficiency can be given.  
Made with Metropix ©2021