





## 2 Englewood Way Glenmore Park NSW

4  2  4 

Calling all investors looking to purchase within the ever growing and extremely popular Glenmore Park Estate. Situated approximately 20km's from the up and coming Western Sydney International Airport, minutes' walk to the local public school and an easy drive to shops, hospitals, and the M4 motorway. Current tenant in lease until April 2022, this property is ideal for the astute investor or those that are not in a hurry to move in.

- + Good sized bedrooms, master with ensuite and walk in robe
- + Separate lounge, rumpus & dining rooms
- + Open light filled kitchen with lots of storage, gas cooking and dishwasher
- + Neat and tidy main bathroom with tub

[For full version visit the website](https://www.aitkenre.com.au/8063411)

**Type** : House  
**Price** : \$ 870,000  
**Building Size** : 175 sqm  
**Land Size** : 569 sqm  
**View** : <https://www.aitkenre.com.au/8063411>



**Diego Benitez**  
**02 4733 6999**

Ground floor  
207.9 sq.m. approx.

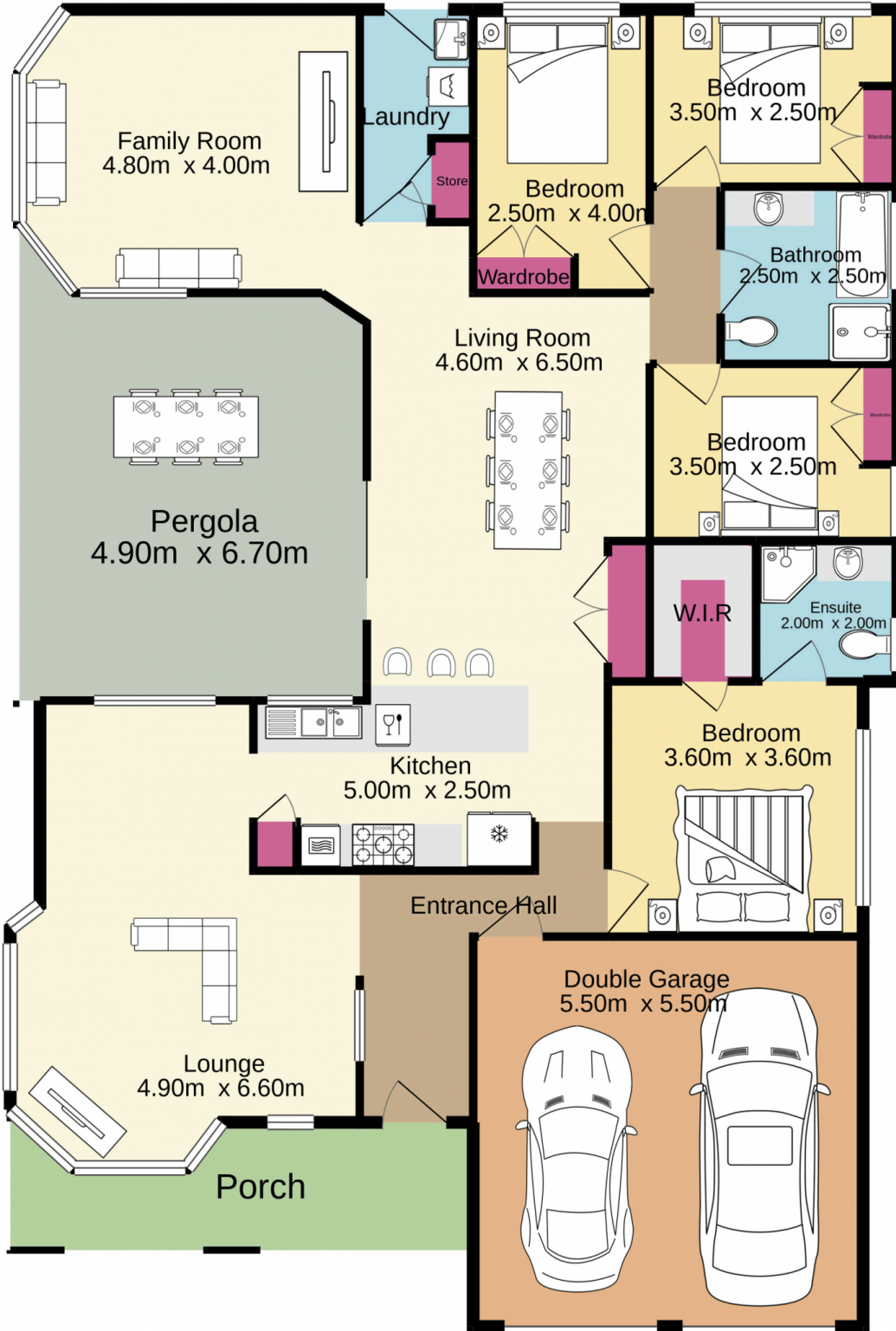

TOTAL FLOOR AREA : 207.9 sq.m. approx.

Whilst every attempt has been made to ensure the accuracy of the floorplan contained here, measurements of doors, windows, rooms and any other items are approximate and no responsibility is taken for any error, omission or mis-statement. This plan is for illustrative purposes only and should be used as such by any prospective purchaser. The services, systems and appliances shown have not been tested and no guarantee as to their operability or efficiency can be given.

Made with Metropix ©2021