



## 14 Mandalong Terrace Glenmore Park NSW

5  3  4 

Perfectly positioned in the desirable Blue Hills Estate, comfortable and convenient family living is easily achieved with its generous, free flowing design which boasts a blend of open plan and private spaces. Formal lounge and dining zones flow to open plan family living offering space for entertaining. A contemporary kitchen with large benchtop and plenty of cupboard space is centrally set to the informal living zones, the downstairs bedroom and full bathroom are perfect for the extended family. Step outside to a covered deck perfect for enjoying time with guests, while looking out to the grassy yard and pool.

### Property Features:

+ 5 Great sized bedrooms, built in robes to 4, walk in robe

[For full version visit the website](https://www.aitkenre.com.au/8063327)

**Type** : House  
**Price** : \$ 942,500  
**Land Size** : 642 sqm  
**View** : <https://www.aitkenre.com.au/8063327>



**Diego Benitez**  
 02 4733 6999

Ground floor  
203.5 sq.m. approx.



1st floor  
80.0 sq.m. approx.

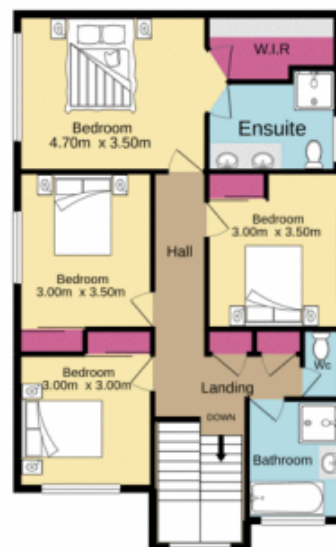

**Jim Aitken**  
Partners

TOTAL FLOOR AREA: 283.6 sq.m. approx.

Whilst every attempt has been made to ensure the accuracy of the floorplan contained here, measurements of doors, windows, rooms and any other items are approximate and no responsibility is taken for any error, omission or mis-statement. This plan is for illustrative purposes only and should be used as such by any prospective purchaser. The services, systems and appliances shown have not been tested and no guarantee as to their operability or efficiency can be given.  
Made with Metropix ©2020

