



45 Glenmore Ridge Drive Glenmore Park NSW

5  2  4 

No matter the season, a comfortable lifestyle is yours to enjoy in this single level residence, situated in the ever popular suburb of Glenmore Park. Taking pride of place on a 524sqm block, this five bedroom home features an enviable list of inclusions, but more importantly a diverse range of living spaces that will suit the entire family. Boasting beautifully presented low maintenance landscaped gardens in the front and the rear, plus two undercover alfresco areas to facilitate barbecues, this home is sure to cater to all your hosting needs, big or small.

- + Five bedrooms
- + Natural gas heating & cooking
- + Stainless steel appliances

Type : House
Price : \$ 795,000
Land Size : 524 sqm
View : <https://www.aitkenre.com.au/8063321>



Diego Benitez
02 4733 6999

[For full version visit the website](https://www.aitkenre.com.au)

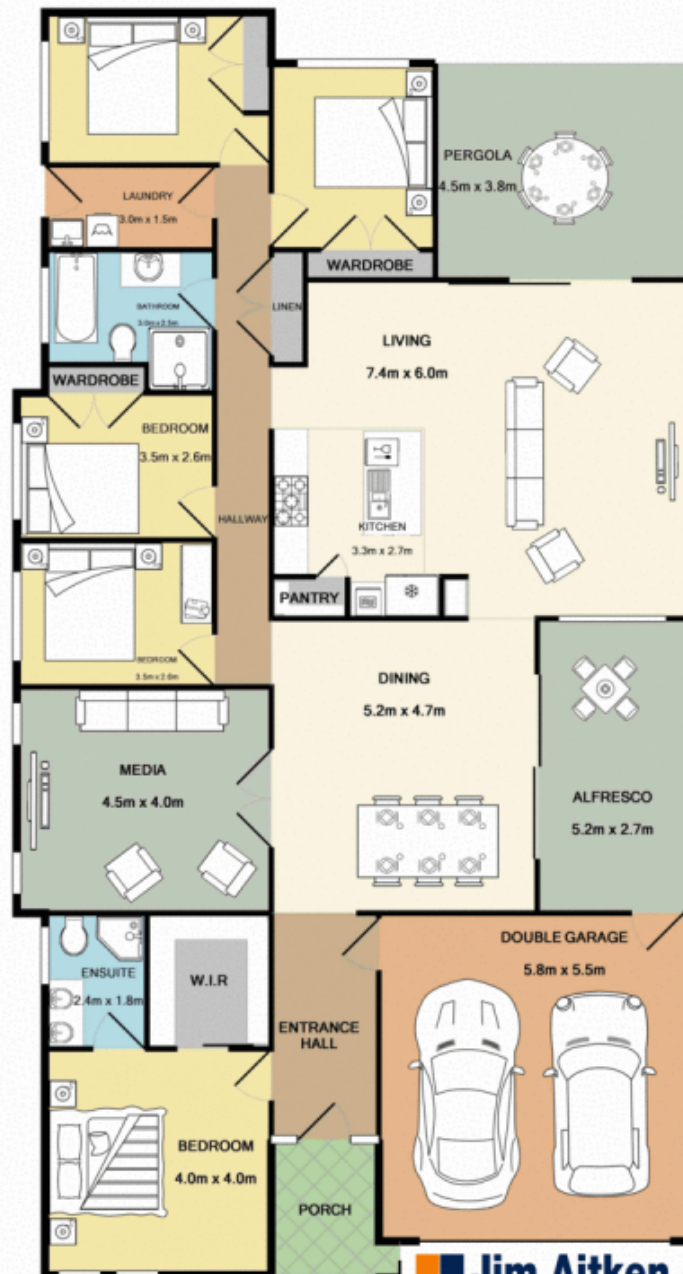

Jim Aitken
Partners

Whilst every attempt has been made to ensure the accuracy of the floor plan contained here, measurements of doors, windows, rooms and any other items are approximate and no responsibility is taken for any error, omission, or mis-statement. This plan is for illustrative purposes only and should be used as such by any prospective purchaser. The services, systems and appliances shown have not been tested and no guarantee as to their operability or efficiency can be given.
Made with Metropix ©2019