

53 Lincoln Drive Cambridge Park NSW

3  1  2 

Located centrally in the quiet suburb of Cambridge Park is this great family home. With a renovated kitchen and bathroom, the hard work is done, but it still offers plenty of room to add value and your personal touch. This property will suit a variety of buyers whether for a first home, an investment or perhaps someone that wants to use the flexible floorplan to turn it into something else entirely.

Type : House
Price : \$ 775,000
Land Size : 613 sqm
View : <https://www.aitkenre.com.au/8062303>

- + Three bedrooms plus study nook
- + Renovated eat in kitchen with floating timber floors
- + Large renovated bathroom with separate bathtub
- + Living/dining room with split system AC
- + Gated driveway with side access to single garage
- + Potential rent return of \$420 - \$440pw
- + Granny flat potential (STCA)

[For full version visit the website](https://www.aitkenre.com.au)

Ground floor

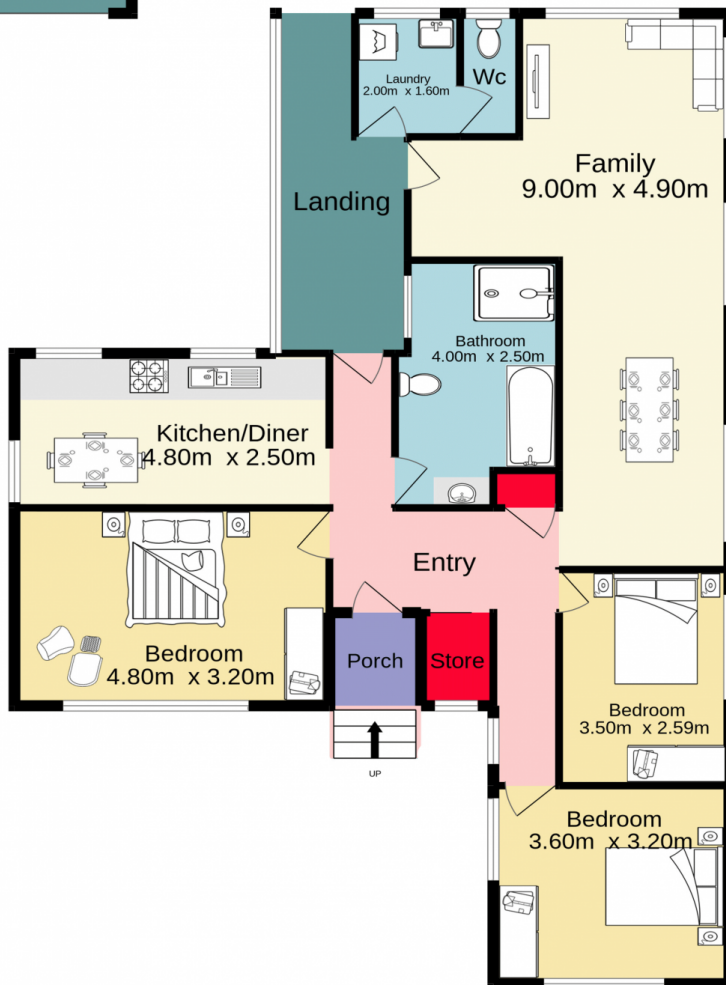
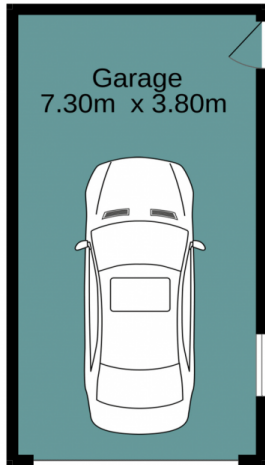

Jim Aitken
+ Partners



Whilst every attempt has been made to ensure the accuracy of the floorplan contained here, measurements of doors, windows, rooms and any other items are approximate and no responsibility is taken for any error, omission or mis-statement. This plan is for illustrative purposes only and should be used as such by any prospective purchaser. The services, systems and appliances shown have not been tested and no guarantee as to their operability or efficiency can be given.
Made with Metropix ©2022