



**131 Richmond Road Cambridge Park NSW**

4 2 6

Make 2021 the year you bought the right house at the right time. With features to suit a variety of buyers whether for a first home, downsize, upsize or a solid investment. Families will love the large rear yard and two bathrooms. While investors will appreciate the large R2 zoned block with granny flat potential (STCA).

**Type** : House  
**Price** : \$ 800,000  
**Land Size** : 556 sqm  
**View** : <https://www.aitkenre.com.au/8062287>

- + Four bedrooms and two updated bathrooms
- + Huge timber kitchen overlooking the second living area
- + Timber floors throughout and bright North Easterly aspect
- + Low maintenance yard with garage and carport
- + Granny flat potential (STCA)
- + Short walk to station and schools
- + Great tenant in place paying \$440pw

[For full version visit the website](https://www.aitkenre.com.au)

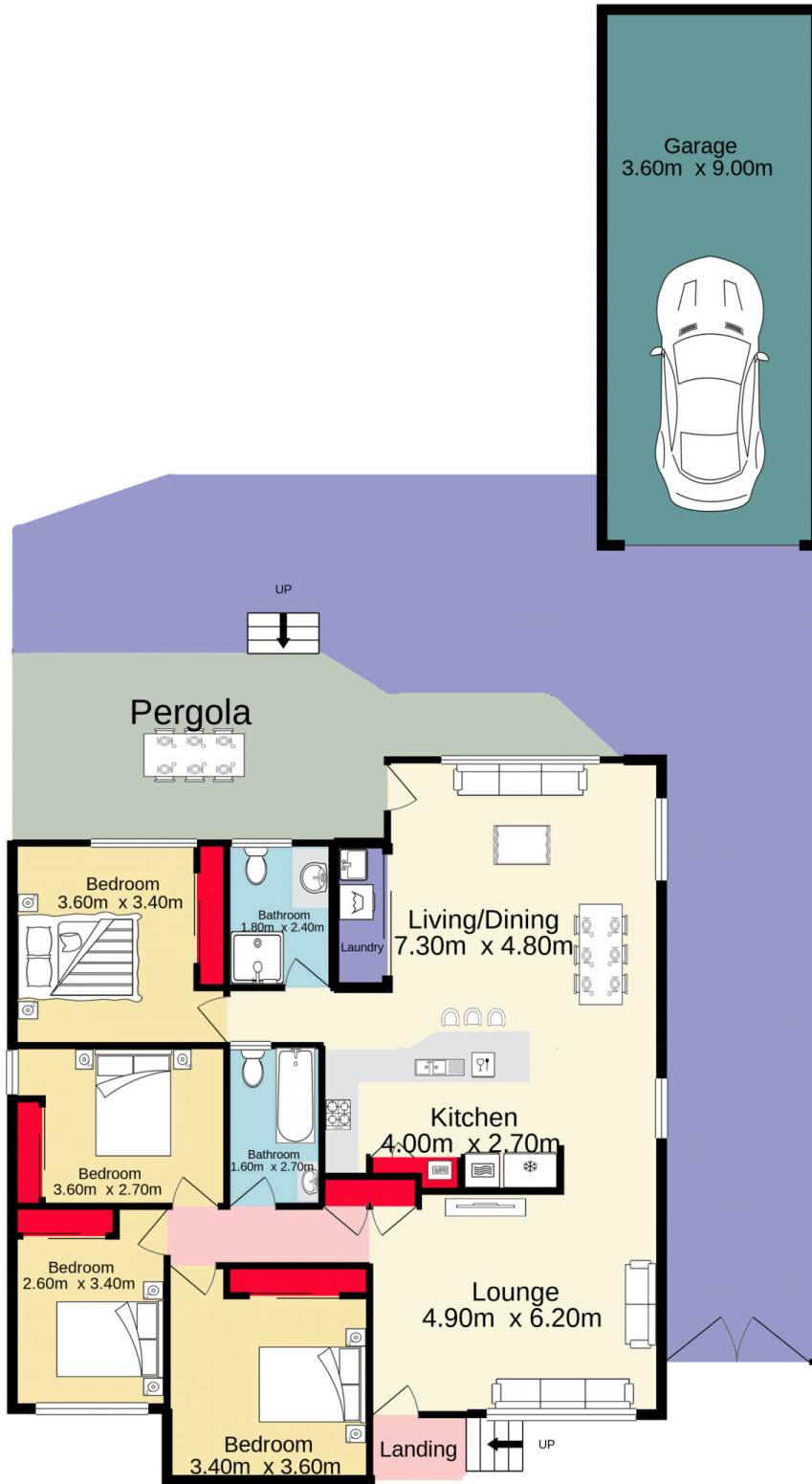

**Jim Aitken**  
+ Partners



Whilst every attempt has been made to ensure the accuracy of the floorplan contained here, measurements of doors, windows, rooms and any other items are approximate and no responsibility is taken for any error, omission or mis-statement. This plan is for illustrative purposes only and should be used as such by any prospective purchaser. The services, systems and appliances shown have not been tested and no guarantee as to their operability or efficiency can be given.  
Made with Metropix ©2021