



55 Pembroke Street Cambridge Park NSW

3  1  2 

Are you looking for a home with nothing more to do? A home that offers good proportions, a modern kitchen, an updated bathroom and a low maintenance yard? Then this is the home for you. Add to that gorgeous period details including, polished timber floors, picture rails, detailed corncing, high ceilings with roses and original brick archways this home just oozes character.

- + Modern kitchen with stone benchtops and stainless steel appliances
- + Polished timber flooring throughout living and bedrooms
- + Updated bathroom with bath plus 2nd separate toilet
- + Low maintenance grassed back yard with undercover area
- + Split system A/C and slow combustion fireplace

Type : House
Price : \$ 662,000
Land Size : 347 sqm
View : <https://www.aitkenre.com.au/8062248>

[For full version visit the website](https://www.aitkenre.com.au)

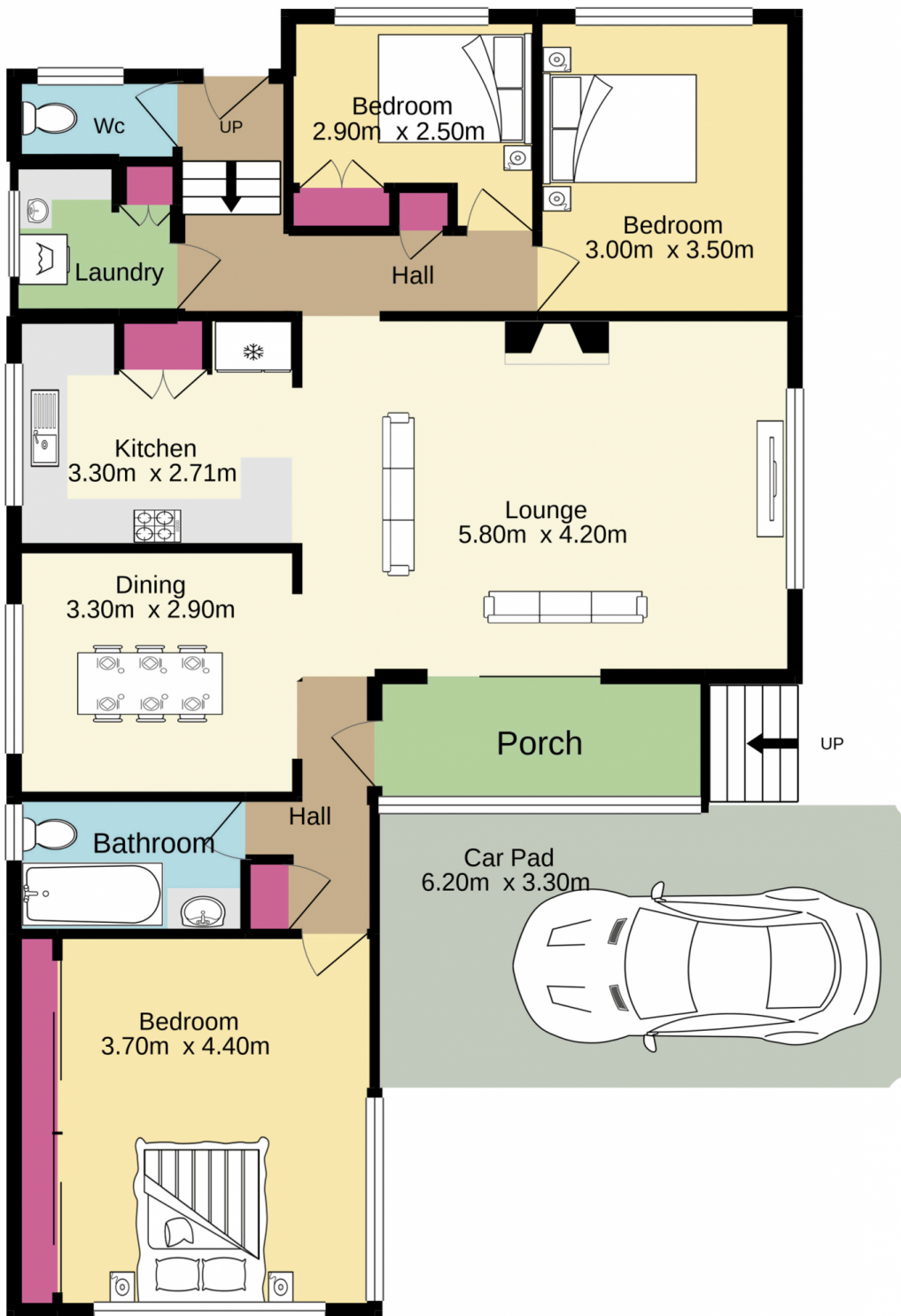

 **Jim Aitken**
Partners

TOTAL FLOOR AREA : 115.6 sq.m. approx.

Whilst every attempt has been made to ensure the accuracy of the floorplan contained here, measurements of doors, windows, rooms and any other items are approximate and no responsibility is taken for any error, omission or mis-statement. This plan is for illustrative purposes only and should be used as such by any prospective purchaser. The services, systems and appliances shown have not been tested and no guarantee as to their operability or efficiency can be given.

Made with Metropix ©2021