





307/60 Lord Sheffield Circuit Penrith NSW

2  2  2 

If you've been looking for a two bedroom unit in the heart of the Penrith CBD then this is a must see. Situated within walking distance of Penrith's best amenities this unit is a perfect opportunity for investors and owner occupiers alike. Upon inspection you will love the sweeping views of Ron Mullock oval and the convenience of a large study. With too many features to list an inspection is a must!

Type : Unit
Price : \$ 500,000
View : <https://www.aitkenre.com.au/8062148>

- + Walking distance to shops and transport
- + Study perfect for working from home
- + Only two years old
- + Corner unit with beautiful views
- + Modern kitchen with gas cooking
- + Split system air conditioning
- + Single car space with storage cage

[For full version visit the website](https://www.aitkenre.com.au)

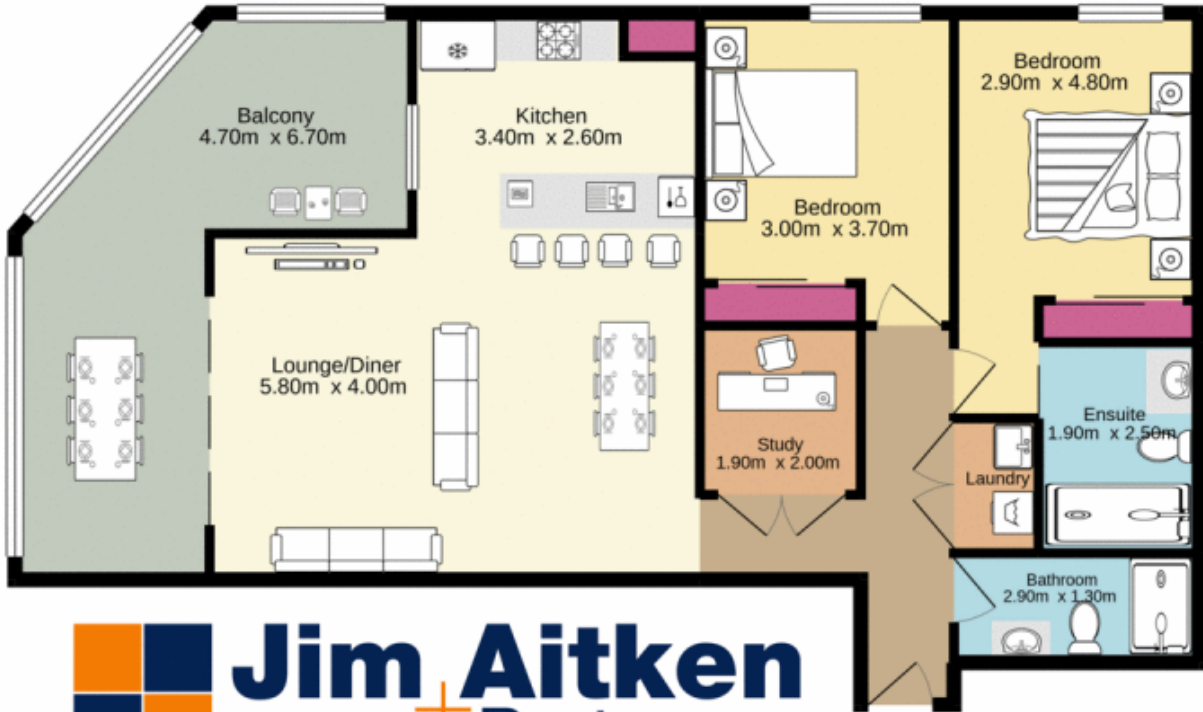

TOTAL FLOOR AREA : 95.4 sq.m. approx.

Whilst every attempt has been made to ensure the accuracy of the floorplan contained here, measurements of doors, windows, rooms and any other items are approximate and no responsibility is taken for any error, omission or mis-statement. This plan is for illustrative purposes only and should be used as such by any prospective purchaser. The services, systems and appliances shown here have not been tested and no guarantee as to their operability or efficiency can be given.
Made with Metropix ©2009

