



8 Hume Crescent Werrington County NSW

4 2 1

I remember first walking into this house. The walls were dark, there was barely any real light, and the carpet was somewhat lacking.

But we saw the potential.

Little by little we peeled back the layers, and finally we revealed the beauty she is today.

Our girl, she isn't a spring chicken. With 1975 etched into the slab in the master bedroom, with a cute foot print as well, we knew we had a great foundation to work with.

Features include:

Type : House
Price : \$ 885,000
Land Size : 651 sqm
View : <https://www.aitkenre.com.au/8061163>



Daniel Hulston
02 4732 5055



Mitch Paxton
02 4732 5055

[For full version visit the website](https://www.aitkenre.com.au)

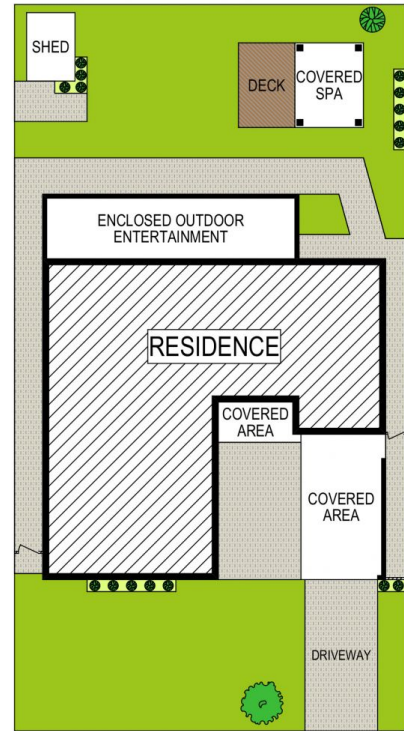
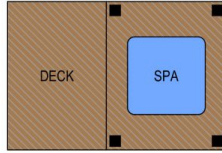

Disclaimer: The above information has been furnished to us by the vendors of the property, Rpdata Google and independent recourses. We have not verified whether or not the information is accurate and do not have any belief one way or the other in its accuracy. We do not accept any responsibility to any person for its accuracy and do no more than pass it on. All interested parties should make their own inquiries in order to determine whether or not this information is in fact accurate.

8 Hume Crescent, Werrington County

