



5 Doncaster Avenue Claremont Meadows NSW

4 🛏 2 🚗 2 🚗

Unfolding over a sprawling 715sqm land parcel, this exceptional residence has been designed to accommodate versatile family living and impresses equally as an everyday retreat or year-round entertainer. Naturally illuminated and commanding a harmonious blend of space, comfort and convenience, the property enjoys an elevated setting on the high side of the street in a highly sought-after pocket of Claremont Meadows. It is central to Caddens Corner, Western Sydney University, M4 motorway and proposed train connection to Western Sydney Airport.

Type : House
Price : \$ 1,235,000
Land Size : 715 sqm
View : <https://www.aitkenre.com.au/8061119>

- Offers a vast collection of casual lounge, dining and living spaces
- Elevated entertainer's deck enjoys a sweeping backyard backdrop



Joey Lustrì
02 4732 5055

[For full version visit the website](https://www.aitkenre.com.au)



First Floor

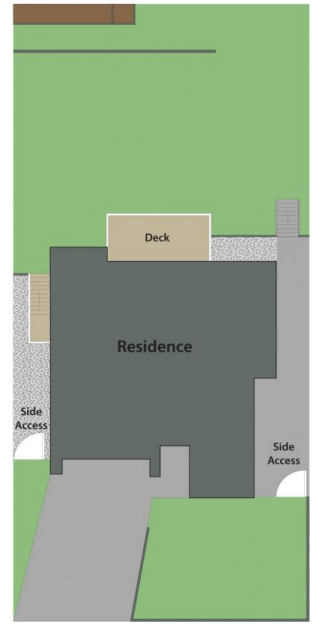

5 Doncaster Ave, Claremont Meadows.

DISCLAIMER: All dimensions herein are approximate and gathered from sources believed to be reliable. Whilst every effort is made for the accuracy of our plans, interested parties should rely on their own enquiries.

