



55 Heaton Avenue CLAREMONT MEADOWS NSW

5 2 2

Setting a new benchmark in opulence and style, this architecturally designed residence basks in an abundance of natural light and offers a streamlined, dual-level design with a vast collection of indoor/outdoor entertaining zones. The interiors feature high-quality, modern inclusions whilst the backyard enjoys a private, leafy setting and swimming pool.

The property occupies a premium 549sqm land parcel and is just moments from the bustling new dining district at Caddens Corner, Western Sydney University, M4 motorway and proposed train connection to Western Sydney Airport.

- Generously proportioned lounge, dining, media and upper

[For full version visit the website](https://www.aitkenre.com.au/8061024)

Type : House
Land Size : 549.6 sqm
View : <https://www.aitkenre.com.au/8061024>



Joey Lustrì
02 4732 5055

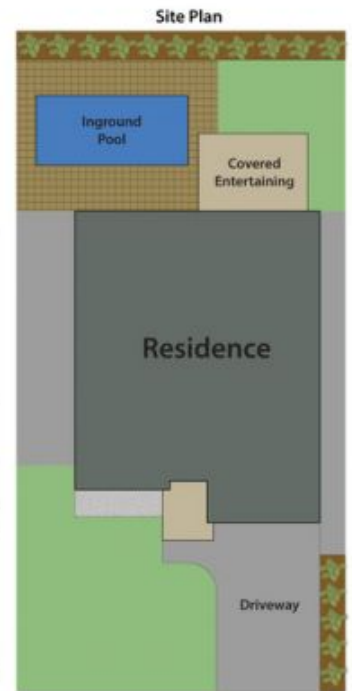
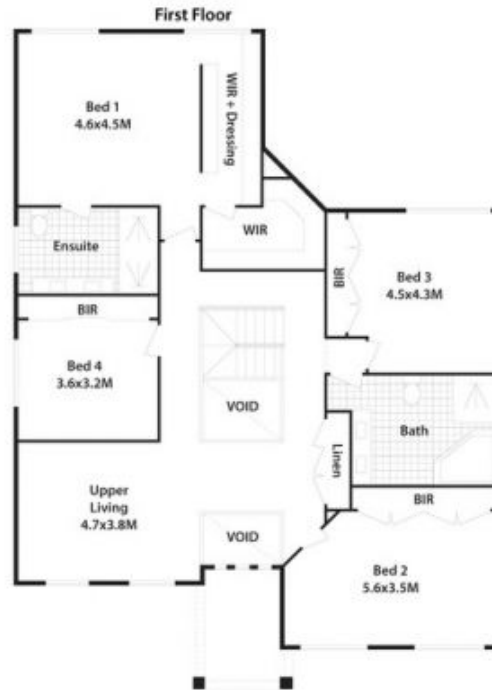
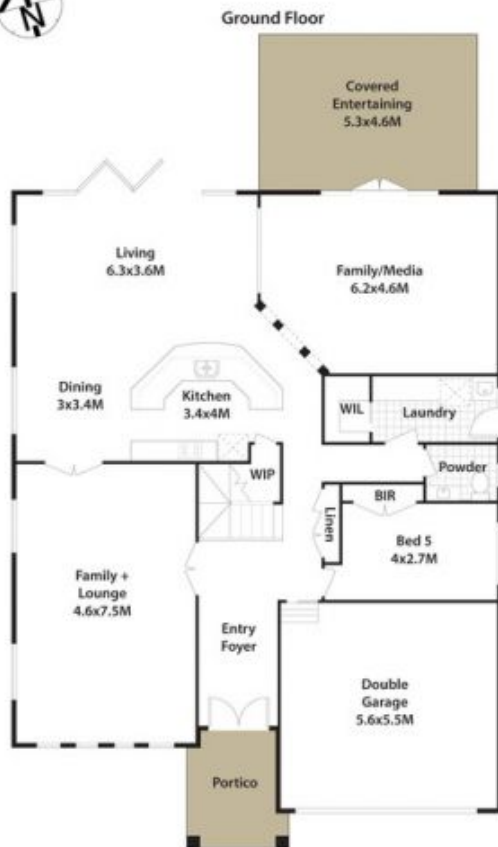

55 Heaton Ave, Claremont Meadows.

DISCLAIMER: All dimensions herein are approximate and gathered from sources believed to be reliable. Whilst every effort is made for the accuracy of our plans, interested parties should rely on their own enquiries.

