



1 Watkin Street JORDAN SPRINGS NSW

4  2  2 

Carefully constructed by Masterton Homes, this idyllic family sanctuary boasts contemporary inclusions, boundless space and fabulous outdoor entertaining.

The expansive living and dining zones seamlessly extend onto a tiled alfresco area overlooking the landscaped garden and outdoor spa. Additional features include a CaesarStone kitchen with quality gas appliances and a walk-in pantry, modern main bathroom with shower and bath, four double bedrooms with mirrored built-in robes, plus a master retreat with an ensuite and his/her walk-in wardrobes. There is a brilliant home theatre that will give you a realistic cinema experience, plus ducted air conditioning, downlights, CCTV alarm system and a double lock-up garage with internal access.

Type : House
Land Size : 460 sqm
View : <https://www.aitkenre.com.au/8061008>



Joey Lustrì
02 4732 5055

[For full version visit the website](https://www.aitkenre.com.au)



DISCLAIMER: All dimensions herein are approximate and gathered from sources believed to be reliable. Whilst every effort is made for the accuracy of our plans, interested parties should rely on their own enquiries.

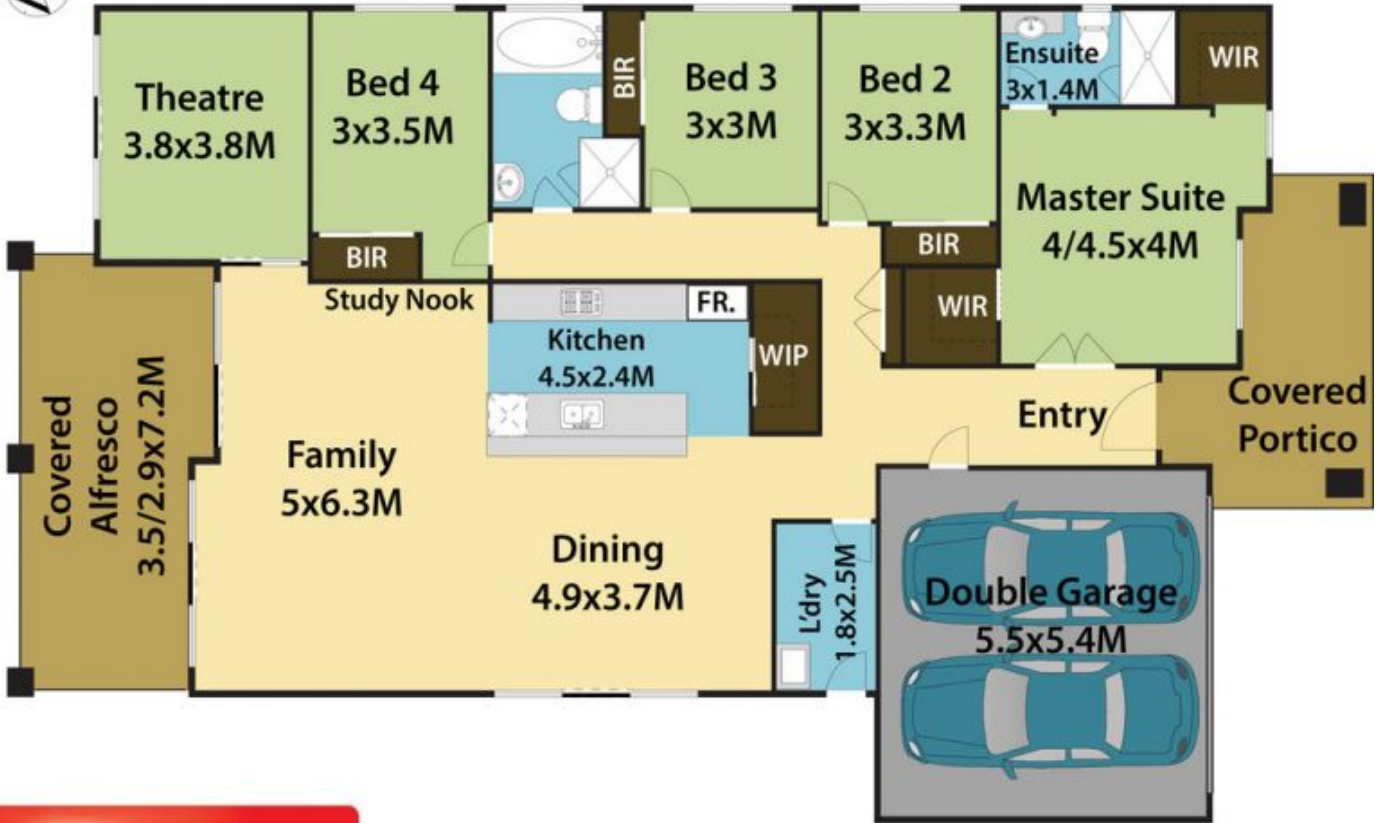

1 Watkin St, Jordan Springs.