



5 Bament Place MINCHINBURY NSW

3  1  1 

Claiming a practical layout that enjoys various multi-purpose entertaining areas, this updated family home introduces a sense of space, comfort and privacy. It is set within a highly sought-after pocket of Minchinbury on a spacious 699sqm land parcel, and is just moments from quality schools, public transport, vibrant shopping and main arterial roads.

- Flowing interiors, multiple living/dining options plus a study nook
- Spacious pergola covered entertaining terrace is perfect for gatherings
- In-ground swimming pool adjoins the child-friendly backyard
- Renovated kitchen with blackboard feature, steel

Type : House
Land Size : 699 sqm
View : <https://www.aitkenre.com.au/8060789>



Joey Lustrì
02 4732 5055

[For full version visit the website](https://www.aitkenre.com.au)

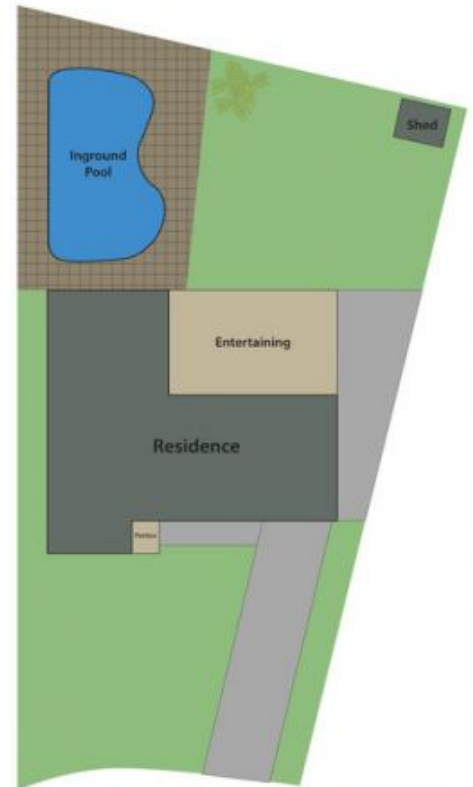
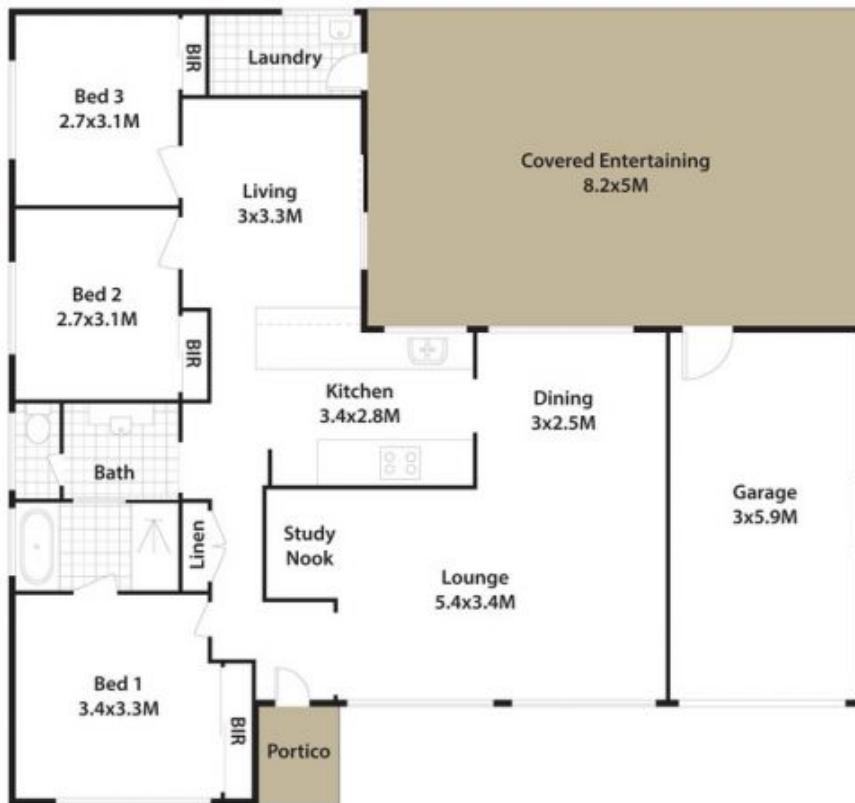

5 Bament Pl, Minchinbury.

DISCLAIMER: All dimensions herein are approximate and gathered from sources believed to be reliable. Whilst every effort is made for the accuracy of our plans, interested parties should rely on their own enquiries.

