



6 Buttercup Street CLAREMONT MEADOWS NSW

5  3  2 

Beautifully presented to offer a north facing family haven with boundless space and quality inclusions, this comfortable residence has been designed to provide effortless indoor/outdoor entertaining over a traditional dual level design. Situated on a spacious 552sqm land parcel this property is located across from a park within a sought-after pocket of Claremont Meadows, central to Caddens Corner, Western Sydney University, M4 motorway and proposed train connection to Western Sydney Airport.

- Collection of spacious living/dining zones over two sunwashed levels
- Extensive covered entertainer's deck fitted with a built-in barbeque

Type : House
Land Size : 552 sqm
View : <https://www.aitkenre.com.au/8060756>



Joey Lustrì
02 4732 5055

[For full version visit the website](https://www.aitkenre.com.au)

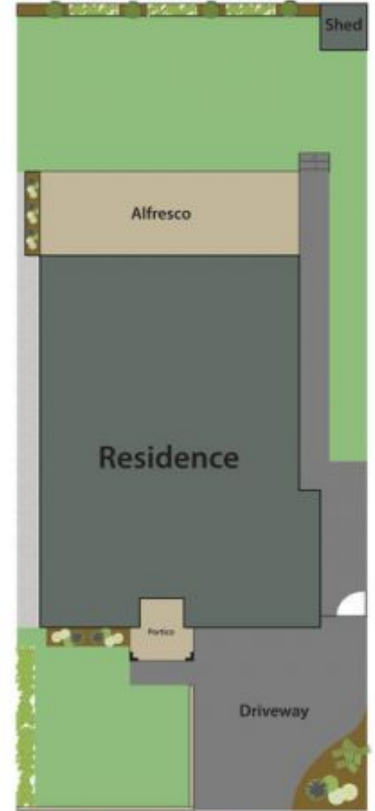
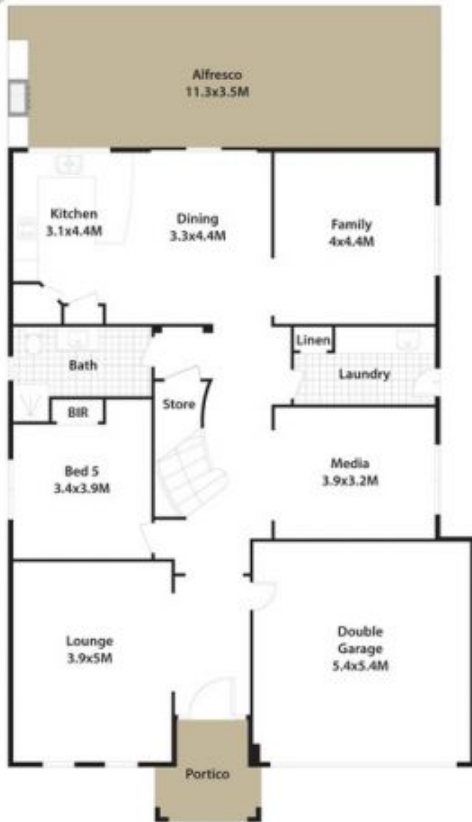

6 Buttercup St, Claremont Meadows.

DISCLAIMER: All dimensions herein are approximate and gathered from sources believed to be reliable. Whilst every effort is made for the accuracy of our plans, interested parties should rely on their own enquiries.

