



20 Mavis Street Rooty Hill NSW

5 2 2

Showcasing a seamless, brand new build, this contemporary family residence is set over a sprawling 1,449sqm block and offers open plan interiors, high-quality finishes and fabulous outdoor entertaining. It is wonderfully located within close proximity to all amenities in Rooty Hill including 400m to Rooty Hill Station and close local eateries and schools.

- Dual level layout offers multiple living and dining zones
- Sliding doors extend out to the large child-friendly backyard
- Relaxed all-weather deck is ideal for effortless entertaining
- Stone island kitchen equipped with stainless steel gas appliances

Type : House
Price : \$ 995,000
Land Size : 1442 sqm
View : <https://www.aitkenre.com.au/8060750>



Joey Lustri
02 4732 5055

[For full version visit the website](https://www.aitkenre.com.au)

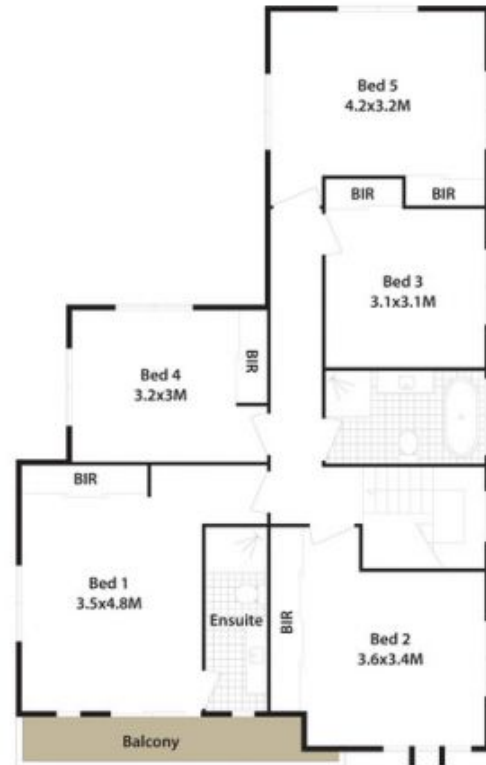
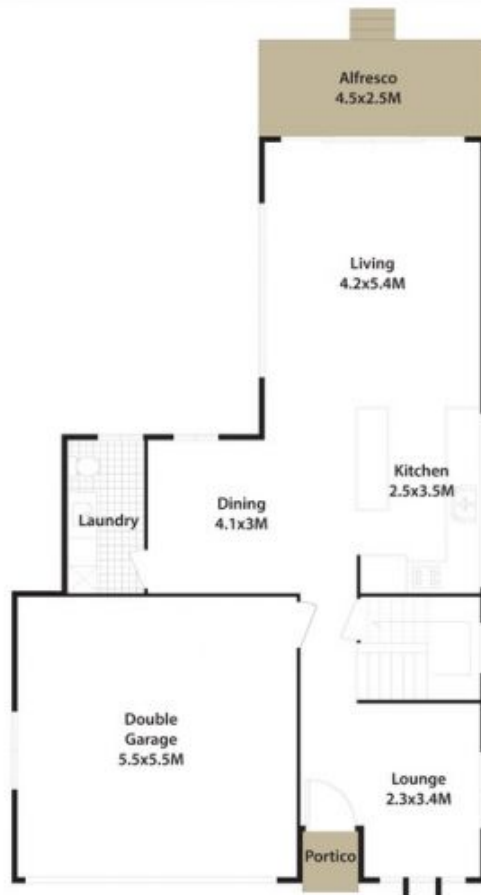

20 Mavis St, Rooty Hill.

DISCLAIMER: All dimensions herein are approximate and gathered from sources believed to be reliable. Whilst every effort is made for the accuracy of our plans, interested parties should rely on their own enquiries.

