





5 & 5A Myrtle Road Claremont Meadows NSW

5  2  1 

Revealing a lucrative opportunity for those seeking dual-income or multi-generation living, this family house and granny flat are each tenanted and yield a combined total of \$1,040 per week. Unfolding over a landscaped 653sqm parcel, each dwelling offers an open concept design with high-quality fittings and private outdoor entertaining. The dual-income property is located within a sought-after pocket of Claremont Meadows, close to Claremont Meadows Public School, Caddens Corner, Penrith CBD and vibrant dining options.

- Primary residence in addition to a granny flat, both enjoy private yard spaces
- Primary home offers a streamlined single-level layout with open living/dining

Type : House
Price : \$ 1,290,000
Land Size : 653 sqm
View : <https://www.aitkenre.com.au/8060745>



Joey Lustrri
02 4732 5055



Manii Kaur
02 4730 1777

[For full version visit the website](https://www.aitkenre.com.au)



Main Residence



Granny Flat

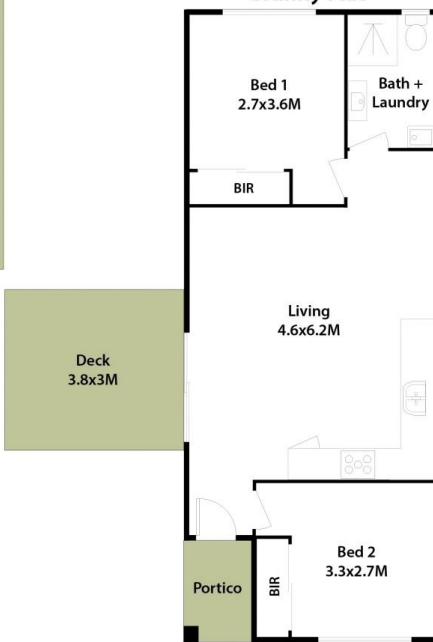

5 + 5A Myrtle Rd, Claremont Meadows.

DISCLAIMER: All dimensions herein are approximate and gathered from sources believed to be reliable. Whilst every effort is made for the accuracy of our plans, interested parties should rely on their own enquiries.

