



2153 ELIZABETH Drive CECIL PARK NSW

4  3  12 

Designed to maximise seamless indoor/outdoor living and entertaining, this stylish family home offers beautifully renovated interiors, abundant space and plenty of natural light. The living zone effortlessly extends through bi-fold doors to an impressive backyard, complete with swimming pool, an enclosed pool cabana with gourmet stainless steel cooking equipment, and sprawling park-like yard. It capitlises on a prime 1.16 hectare block and is located close to the M7 motorway, Mamre Road, the proposed M12 motorway, Badgerys Creek Airport and upcoming infrastructure.

Type : House
Land Size : 11600 sqm
View : <https://www.aitkenre.com.au/8060741>

Interior

- Expansive open plan lounge, kitchen and dining with air

[For full version visit the website](https://www.aitkenre.com.au)

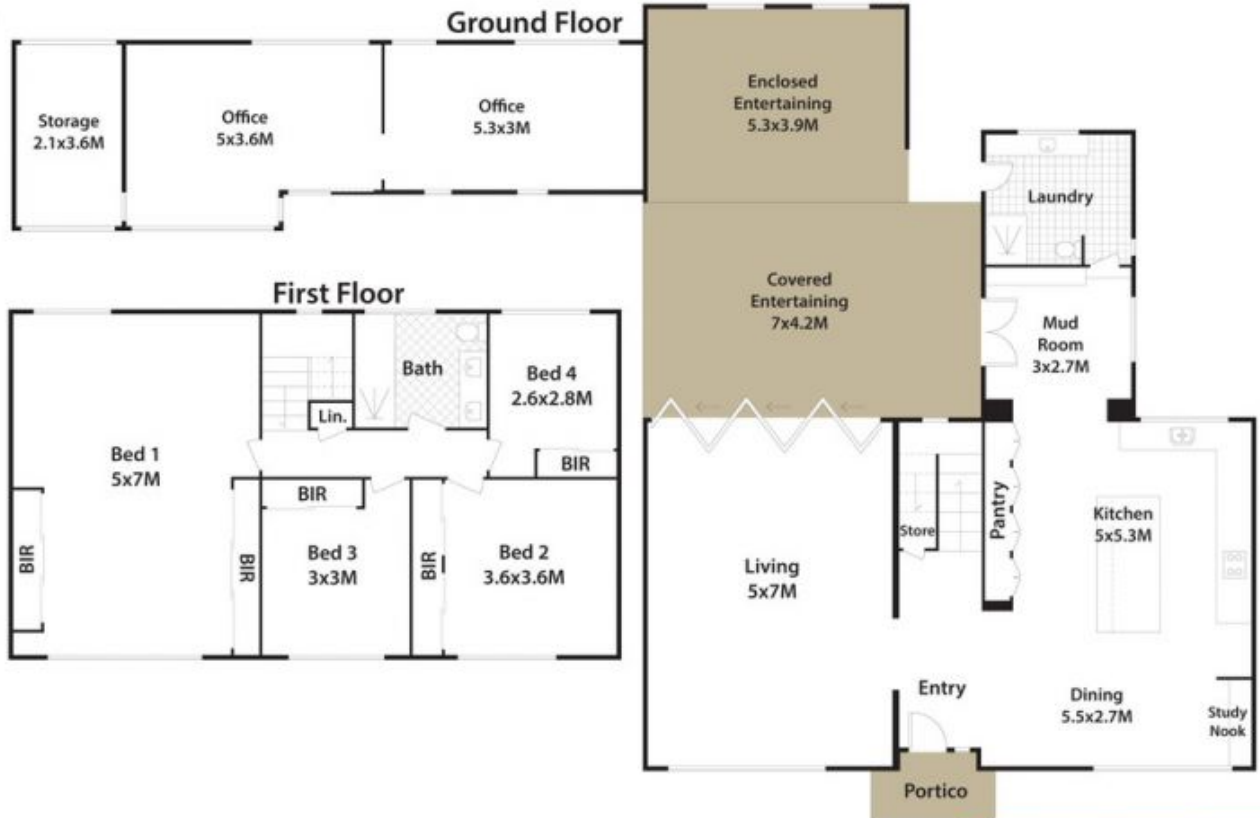

2153 Elizabeth Dr, Cecil Park.

DISCLAIMER: All dimensions herein are approximate and gathered from sources believed to be reliable. Whilst every effort is made for the accuracy of our plans, interested parties should rely on their own enquiries.

