



10 GIBSON Street SILVERDALE NSW

4 2 3

Set on a sprawling 981sqm block, this readymade family home is washed with an abundance of natural light and provides multiple indoor/outdoor spaces to relax and enjoy. The backyard is low maintenance and extensive, providing ample space for children, pets and effortless family entertaining.

It offers a teenage retreat/loft space ideal for storage and is located close to local shops, parks and public transport.

- Sunken living/media room plus open family and dining
- 14m x 5m alfresco overlooks the yard and mature trees
- Rear gazebo adjoins the easycare child-friendly garden
- Tidy kitchen with stainless steel appliances and 900mm cooktop
- Four good-sized bedrooms with built-in wardrobes

Type : House
Land Size : 981 sqm
View : <https://www.aitkenre.com.au/8060722>



Damian Sexton

[For full version visit the website](https://www.aitkenre.com.au)

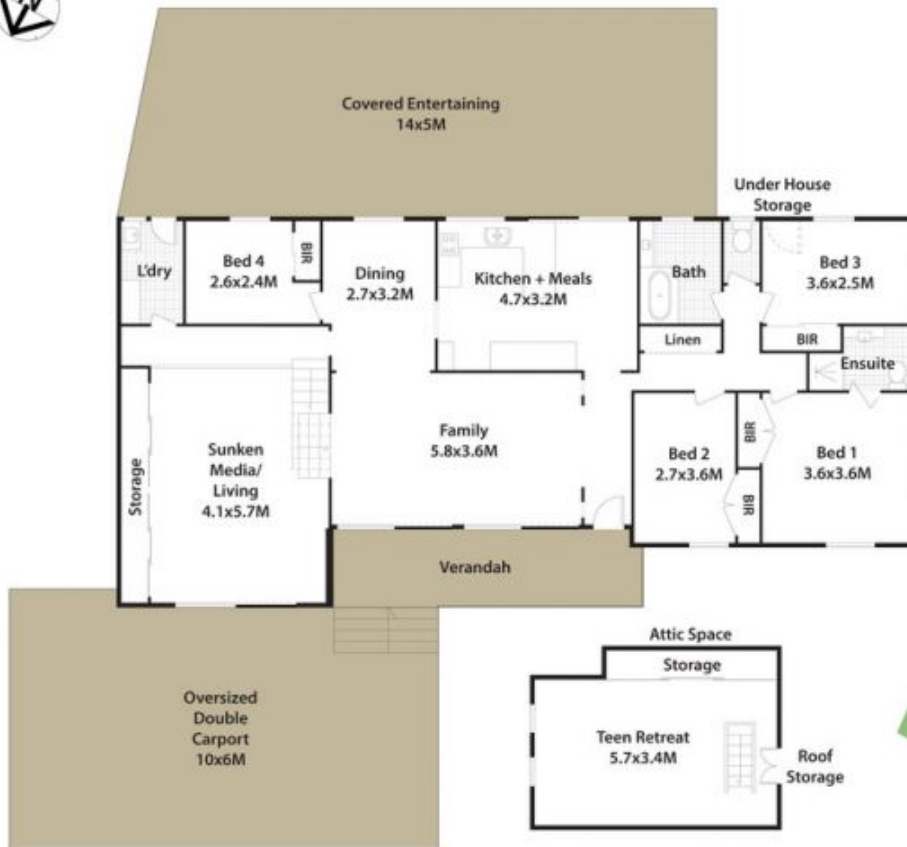

10 Gibson St, Silverdale.

DISCLAIMER: All dimensions herein are approximate and gathered from sources believed to be reliable. Whilst every effort is made for the accuracy of our plans, interested parties should rely on their own enquiries.

