



69 Pandorea Street CLAREMONT MEADOWS NSW

4 2 2

Situated on a spacious 569sqm land parcel and designed to offer a lifestyle of effortless luxury, this Eden Brae home is just over 3 years old and provides versatile family living with pristine modern details, high-end inclusions, in-ground swimming pool and private outdoor entertaining. It's nestled in a highly sought-after pocket and the opportunity to secure a property in this area is extremely rare.

This home is peacefully set opposite native bushland, and is located just moments from the University of Western Sydney, TAFE, public transport, M4 motorway and the upcoming Caddens Corner.

- Sleek single level design offers multiple lounge, dining and family zones

Type : House
Land Size : 569 sqm
View : <https://www.aitkenre.com.au/8060702>



Joey Lustri
02 4732 5055

[For full version visit the website](https://www.aitkenre.com.au)

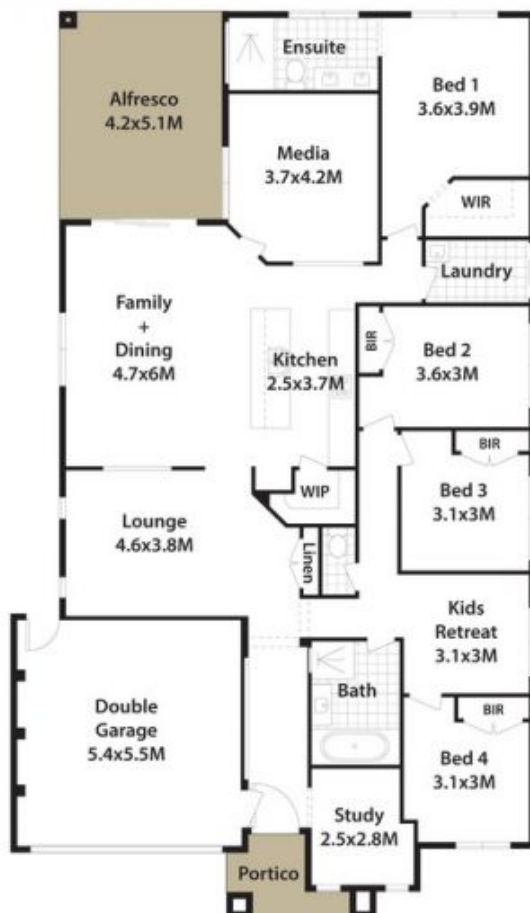

69 Pandorea St, Claremont Meadows.

DISCLAIMER: All dimensions herein are approximate and gathered from sources believed to be reliable. Whilst every effort is made for the accuracy of our plans, interested parties should rely on their own enquiries.

