





23-23A Carrington Street ST MARYS NSW

6  2  2 

Offering a fantastic dual-income opportunity, this house and granny flat both offer practical single level layouts with spacious interiors. This property is situated a large 645sqm land parcel in a high growth area.

This property is ideally suited to astute investors or large families seeking in-law accommodation or additional income. It is conveniently located close public transport, local shops, quality schools and main arterial roads including the M4 Motorway.

Main house

- Flowing interiors provide multiple living/dining zones
- Updated kitchen with gas appliances and ample cupboard space

Type : House
Land Size : 645 sqm
View : <https://www.aitkenre.com.au/8060699>



Joey Lustrì
02 4732 5055

[For full version visit the website](https://www.aitkenre.com.au)



Main House

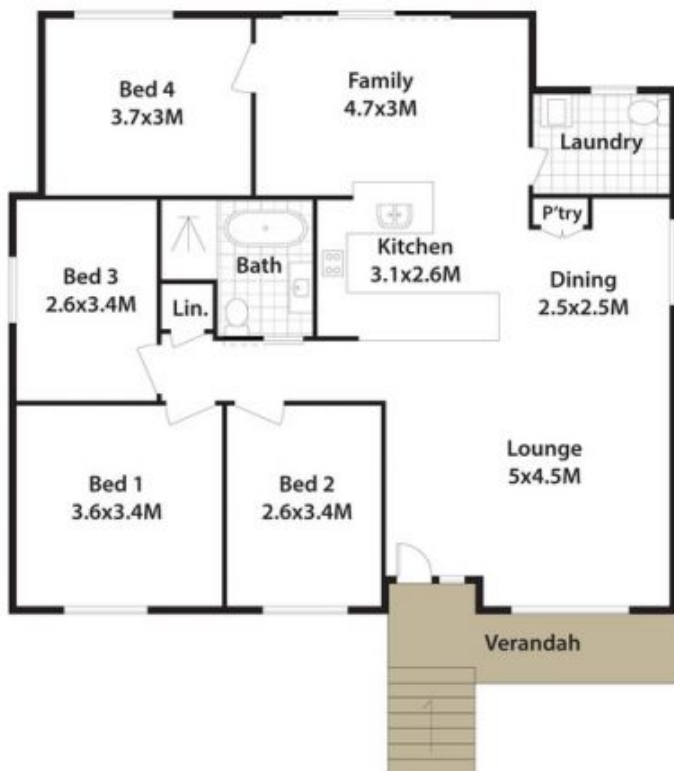

Granny Flat



23 Carrington St, St Marys.

DISCLAIMER: All dimensions herein are approximate and gathered from sources believed to be reliable. Whilst every effort is made for the accuracy of our plans, interested parties should rely on their own enquiries.

