



12 Montague Drive JORDAN SPRINGS NSW

4  2  2 

Situated on a prime corner block within a family-friendly enclave, this residence presents a flowing open concept design, a practical floor plan and modern inclusions throughout. Complete with a number of everyday conveniences, Jordan Springs is a friendly, active community made up of eateries, cycling tracks, sporting grounds, gymnasiums and its own shopping centre.

- Spacious lounge/dining zone seamlessly extends onto a rear patio
- Relaxed outdoor area provides a wonderful setting to entertain
- Well maintained kitchen features stainless steel gas appliances
- Four good-sized bedrooms each fitted with mirrored

Type : House
Land Size : 471 sqm
View : <https://www.aitkenre.com.au/8060688>



Joey Lustrì
02 4732 5055

[For full version visit the website](https://www.aitkenre.com.au)

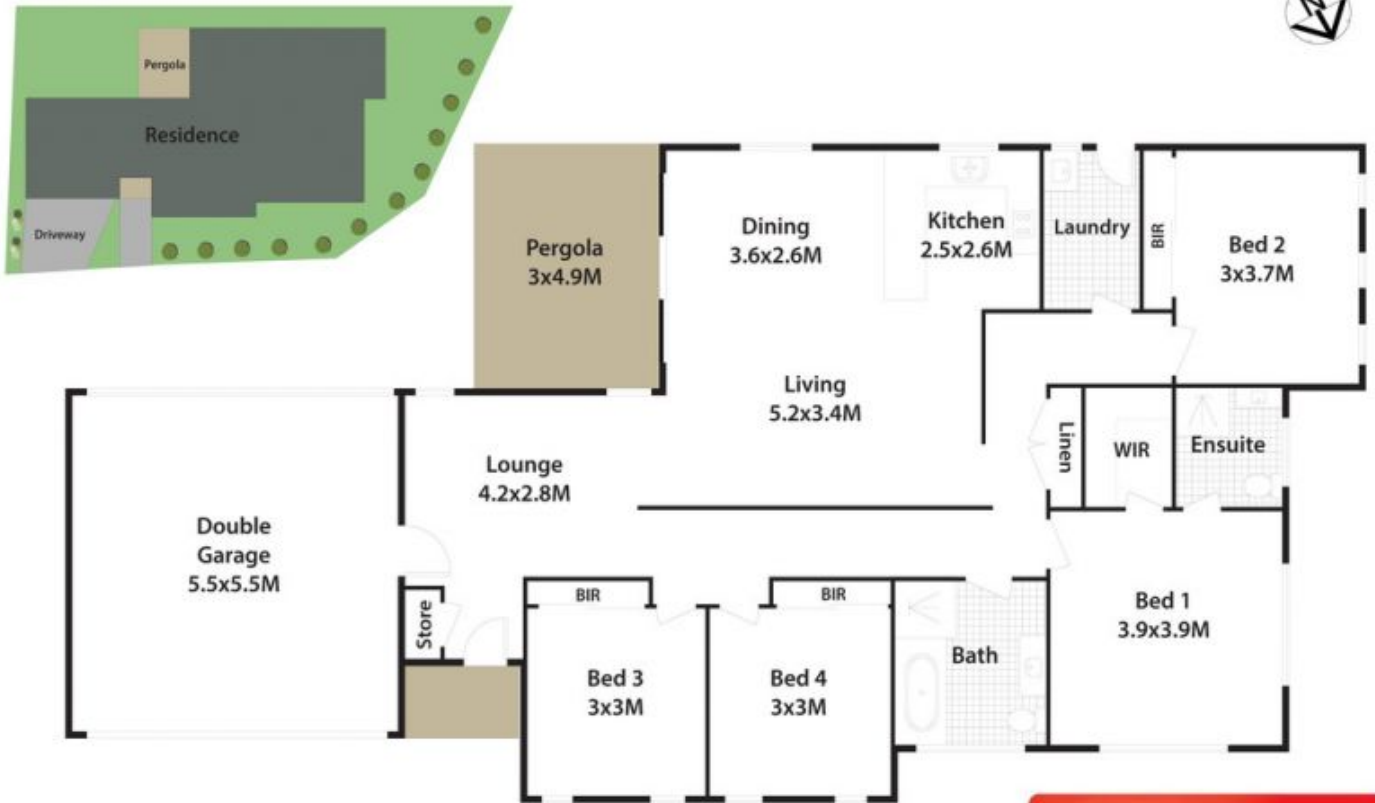

12 Montague Dr, Jordan Springs.

DISCLAIMER: All dimensions herein are approximate and gathered from sources believed to be reliable. Whilst every effort is made for the accuracy of our plans, interested parties should rely on their own enquiries.

