



25 GREEN HILLS Drive SILVERDALE NSW

5 3 4

Embraced by streamlined established gardens on an elevated one acre block, this exceptional master residence is finely crafted for effortless indoor/outdoor entertaining and spectacular family living. It is spread over a sleek single level design and will appeal to buyers seeking space, privacy and comfort.

Positioned behind private hedging in a sought-after neighborhood, the property is only minutes from the heart of Silverdale town centre.

Features:-

- Collection of five versatile living spaces, main lounge includes a wet bar and fridge
- Equipped cinema with seven reclining theater chairs, projector and full width screen

Type : House
Building Size : 50 sqm
Land Size : 4056 sqm
View : <https://www.aitkenre.com.au/8060684>



Damian Sexton

[For full version visit the website](https://www.aitkenre.com.au)



DISCLAIMER: All dimensions herein are approximate and gathered from sources believed to be reliable. Whilst every effort is made for the accuracy of our plans, interested parties should rely on their own enquiries.

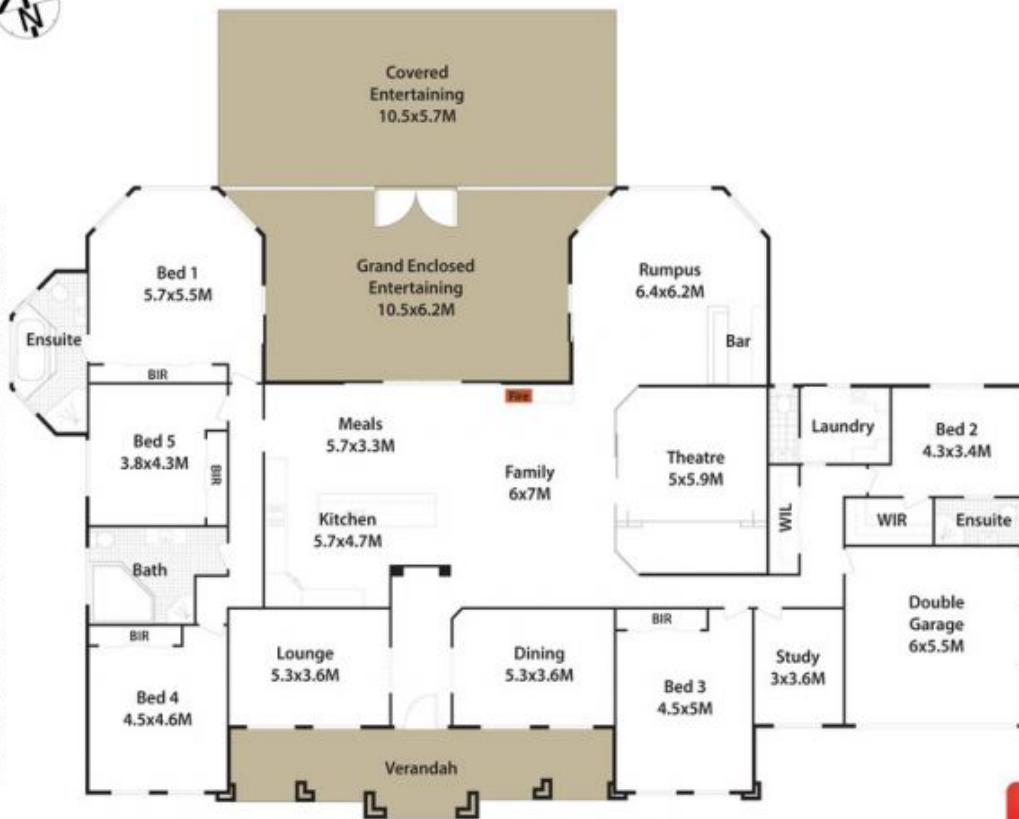

25 Green Hills Dr, Silverdale.

