



7 RIDGEHAVEN Road SILVERDALE NSW

4  2  3 

Sprawled over one acre of meticulously manicured grounds and offered to the market for the first time in 30 years, this original home has been carefully established to offer families a comfortable living environment with several indoor/outdoor spaces to entertain.

Type : House
Land Size : 4004 sqm
View : <https://www.aitkenre.com.au/8060676>

Constructed upon a concrete slab, the property is perfectly positioned to take advantage of the prized Rear to North Aspect and enjoys a serene rural outlook. It's peacefully located close to Silverdale Shopping Village, local schools and bus stop.

- Single level layout with separate living, dining and lounge rooms
- Front lounge enjoys a fireplace and extends outdoors

[For full version visit the website](https://www.aitkenre.com.au)

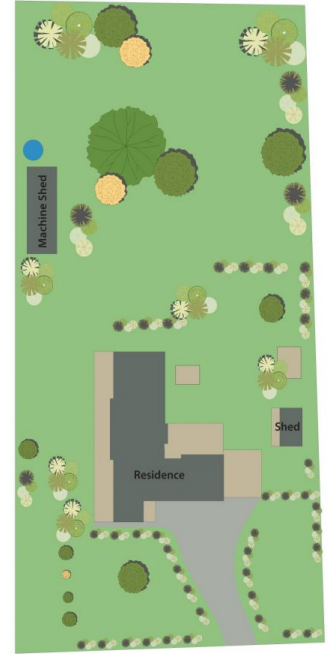

DISCLAIMER: All dimensions herein are approximate and gathered from sources believed to be reliable. Whilst every effort is made for the accuracy of our plans, interested parties should rely on their own enquiries.

7 Ridgeway Rd, Silverdale.

