



### 3 MOOREHEAD Avenue SILVERDALE NSW

4  2  2 

Offered to the market for the first time, this beautifully cared for property is awaiting its next family. Located at the end of a whisper quiet cul-de-sac this well maintained family home sits perfectly on a rare 1,762 sqm block.

**Type** : House  
**Land Size** : 1762 sqm  
**View** : <https://www.aitkenre.com.au/8060665>

This spacious 4 bedroom, 2 bathroom home is perfect for someone looking to move to that leafy established street without compromising on space inside and out. The property offers an oversized double carport at the front of the home, wide side access and ample space for a boat or caravan.

If you're looking for a tranquil lifestyle change or just a new family home on a huge block then give Aimee Mitchell or Damian Sexton a call today to register your interest and

[For full version visit the website](https://www.aitkenre.com.au)

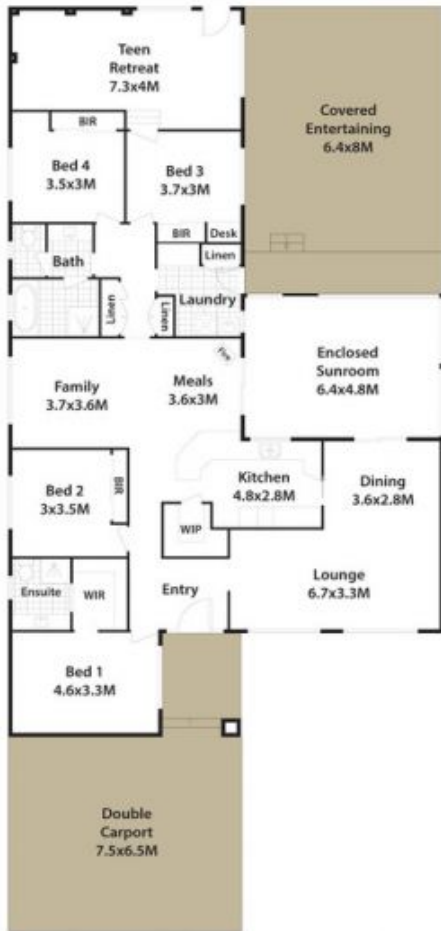

DISCLAIMER: All dimensions herein are approximate and gathered from sources believed to be reliable. Whilst every effort is made for the accuracy of our plans, interested parties should rely on their own enquiries.

**3 Moorehead Ave, Silverdale.**

