





22 RIDGEHAVEN Road SILVERDALE NSW

4  2  6 

Rarely offered to market, this well proportioned half acre block is perfect for the growing family. With a well built and well maintained family home and offering good side access this will appeal to even the most astute buyer.

This north facing home offers four good sized bedrooms, two well kept bathrooms and multiple living spaces with the possibility of converting one of the living spaces into a home office or 5th bedroom.

With outdoor entertaining, pool, side access for the rear shed and garaging this property is perfect for the home handy man, tradie or simply all the big boy's toys.

With half acre properties being so scarce to market this

[For full version visit the website](https://www.aitkenre.com.au/8060663)

Type : House
Land Size : 2133 sqm
View : <https://www.aitkenre.com.au/8060663>



Damian Sexton

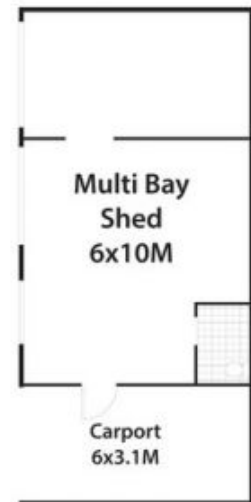
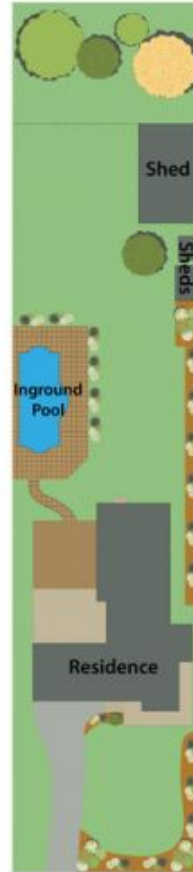
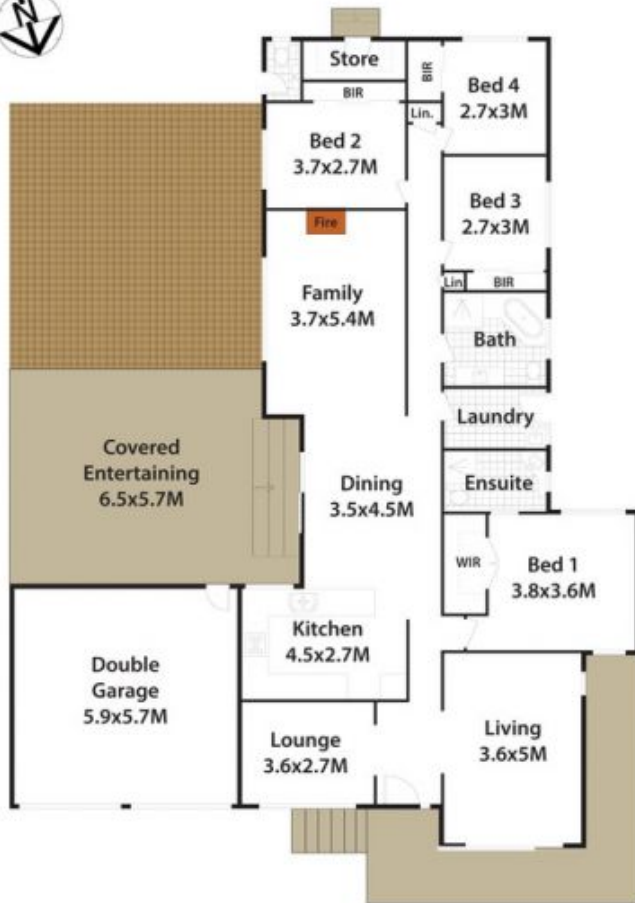

DISCLAIMER: All dimensions herein are approximate and gathered from sources believed to be reliable. Whilst every effort is made for the accuracy of our plans, interested parties should rely on their own enquiries.

22 Ridgehaven Rd, Silverdale.

