



35 Portsmouth Circuit JORDAN SPRINGS NSW

3  2  1 

Built to deliver easy living and entertaining, this streamlined residence showcases quality inclusions, multiple living spaces and wonderful indoor/outdoor entertaining. It provides a convenient yet private lifestyle within the highly sought-after suburb of Jordan Springs.

Type : House
Land Size : 330 sqm
View : <https://www.aitkenre.com.au/8060661>

Complete with a number of everyday conveniences, Jordan Springs is a friendly, active community made up of eateries, cycling tracks, sporting grounds, gymnasiums and its own shopping centre.



Joey Lustrì
02 4732 5055

- Practical layout, two living areas, dual outdoor flow
- Stylish kitchen featuring stone bench-tops, stainless steel appliances, gas cooking and ample cupboard space
- Three good-sized bedrooms, each fitted with built-in robes

[For full version visit the website](https://www.aitkenre.com.au)

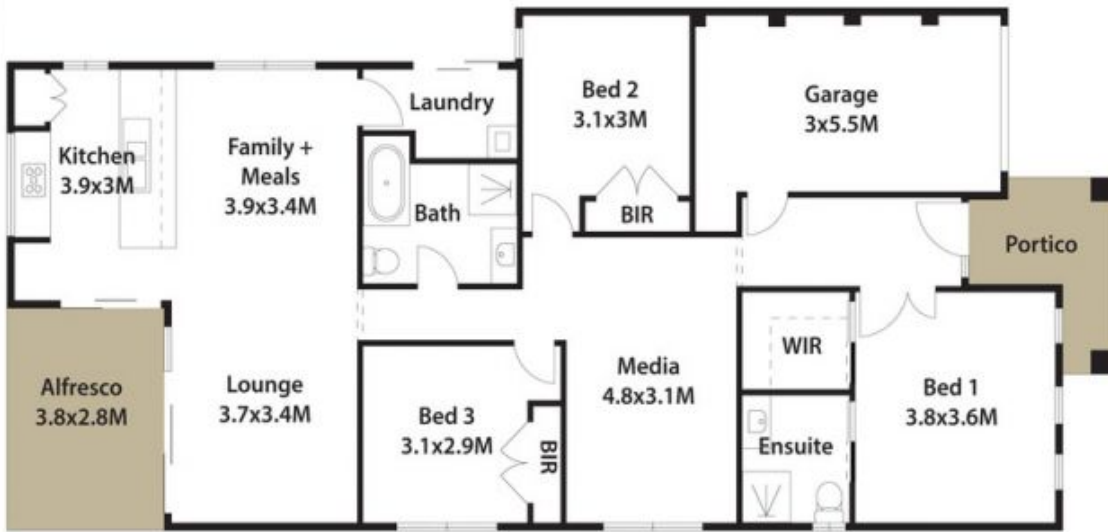

DISCLAIMER: All dimensions herein are approximate and gathered from sources believed to be reliable. Whilst every effort is made for the accuracy of our plans, interested parties should rely on their own enquiries.

35 Portsmouth Cct, Jordan Springs.

