





## 65 TAYLORS Road SILVERDALE NSW

4  2  3 

Wrapped in established gardens to create a sense of peace and privacy, this streamlined family home is set back from the street on a sweeping 1,358sqm block.

The modern interiors enjoy a collection of living zones with seamless indoor/outdoor flow to fantastic entertainers' deck and child-friendly yard.

It is located close to Silverdale shops, local schools and bus stops.

- Open plan living/meals plus a family room and lounge/dining
- Easy access to the pergola covered alfresco area and backyard
- Stone kitchen with stainless steel appliances, walk-in pantry

**Type** : House

**Land Size** : 1385 sqm

**View** : <https://www.aitkenre.com.au/8060599>

[For full version visit the website](https://www.aitkenre.com.au)

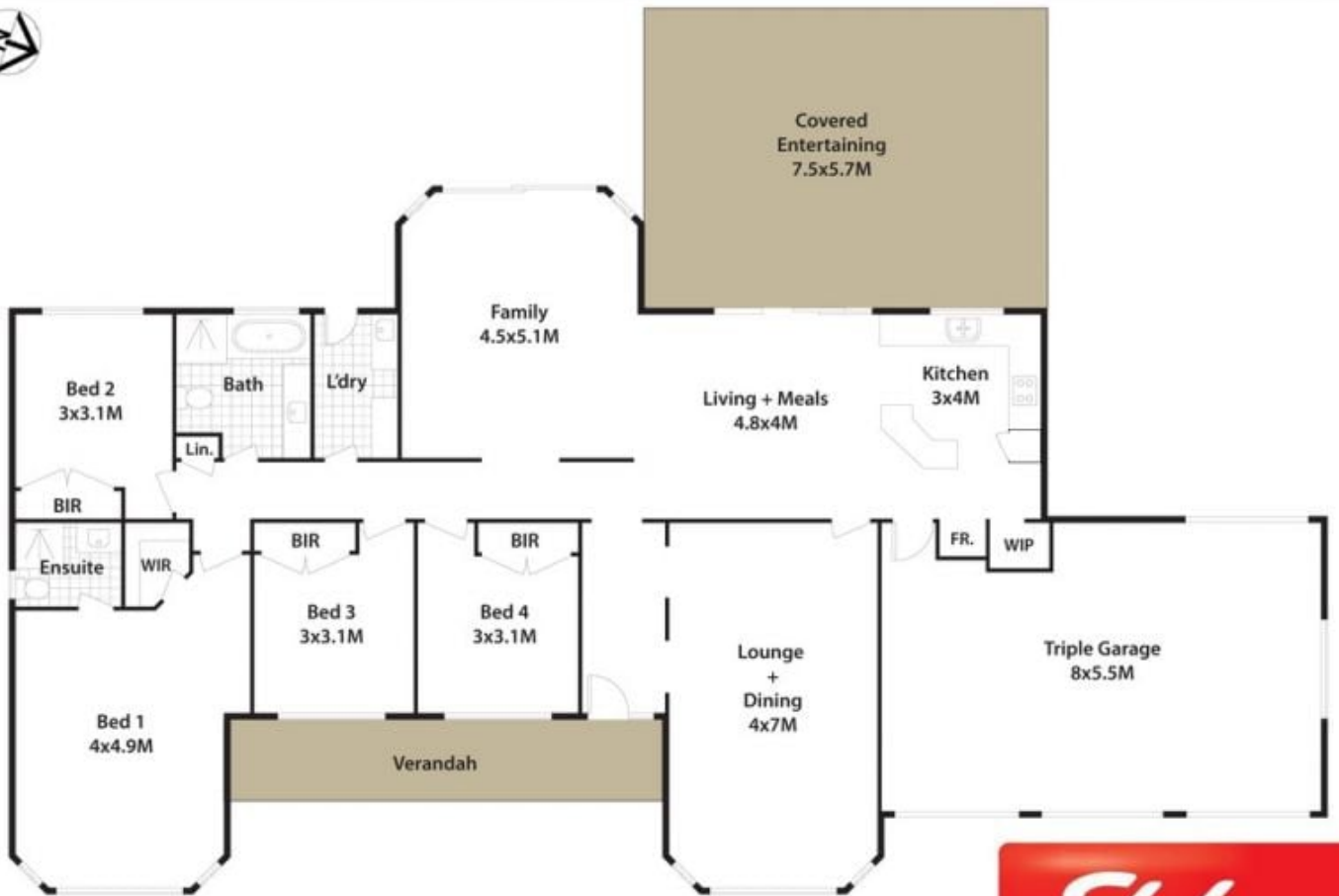

**65 Taylors Rd, Silverdale.**

DISCLAIMER: All dimensions herein are approximate and gathered from sources believed to be reliable. Whilst every effort is made for the accuracy of our plans, interested parties should rely on their own enquiries.

