



1/2 YEELANNA Place KINGSWOOD NSW

4  1  1 

Presenting this four bedroom home in the Orchard Hills Estate in a house proud and quiet cul-de-sac that is a perfect family home or for the astute Investor looking to enhance their portfolio.

Type : House
Land Size : 493 sqm
View : <https://www.aitkenre.com.au/8060593>

Step inside and feel the character of this home with its polished floor boards and L shaped living and dining leading onto the kitchen. The three bedrooms are all newly carpeted, with a built in robe to the master bedroom. The property is air conditioned for comfort all year round. All this on a 493sqm block, within very close proximity to local schools, train station, university, hospital and easy access to the M4.



Damian Sexton

The home is currently rented and would be an easy

[For full version visit the website](#)

Detached
Garage
3x5.5M

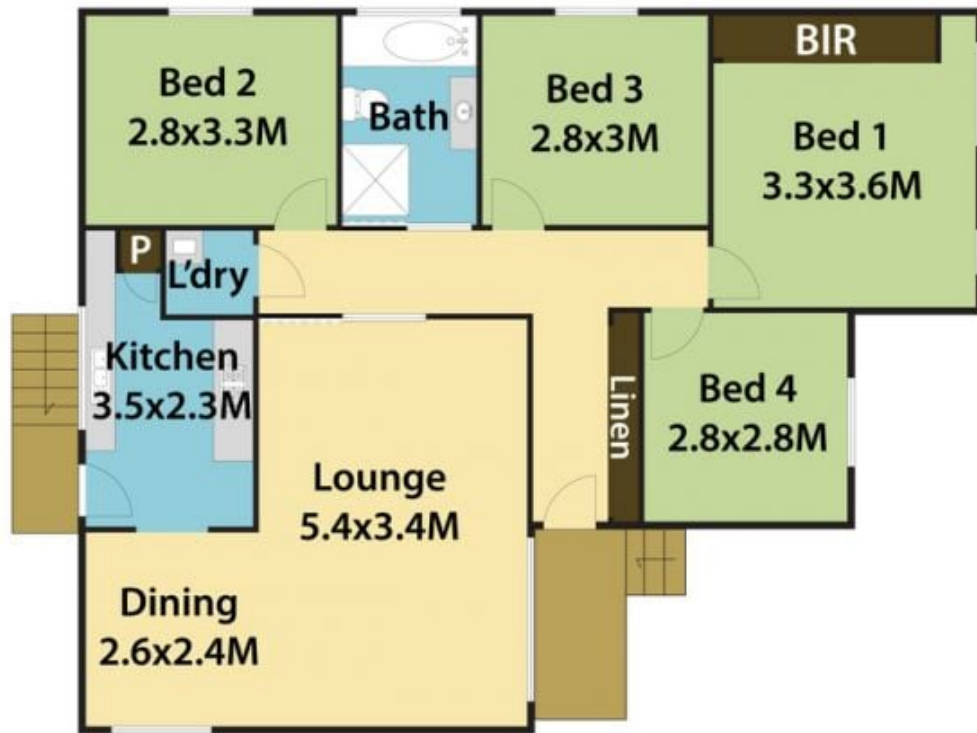
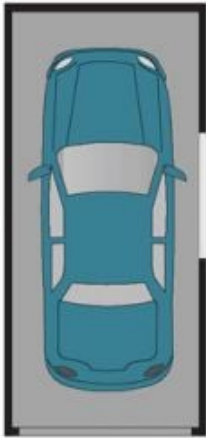

1/2 Yeelanna Pl, Kingswood.

