



31 Pardalote Place GLENMORE PARK NSW

4  1  1 

Wonderfully designed, this recently updated home boasts quality inclusions, an abundance of space and fantastic outdoor entertaining.

This well presented property appeals to all buyers with its versatile floor plan. The property boasts 4 good-sized bedrooms, spacious living and dining zone and is situated on a 488sqm easy maintenance land parcel.

This delightful home is nestled in a quiet street and is close to Primary and High Schools, Glenmore Park Town Centre, Public Transport and the M4 Motorway.

- 4 good-sized bedrooms
- Large undercover area perfect for entertaining

Type : House
Land Size : 488 sqm
View : <https://www.aitkenre.com.au/8060582>



Joey Lustrì
02 4732 5055

[For full version visit the website](https://www.aitkenre.com.au)

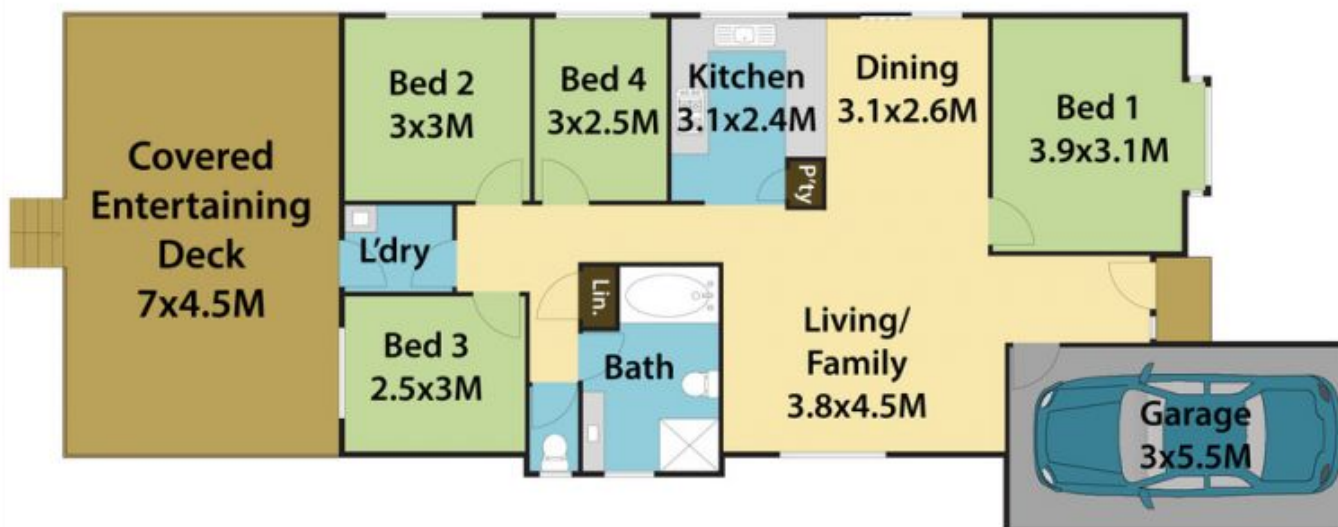

31 Pardalote Pl, Glenmore Park.

DISCLAIMER: All dimensions herein are approximate and gathered from sources believed to be reliable. Whilst every effort is made for the accuracy of our plans, interested parties should rely on their own enquiries.

