



**2 Enfield Street JAMISONTOWN NSW**

3 1 4

View by appointment

This immaculate family home presents great opportunity for buyers who are looking for a great home in a family-friendly and ultra convenient location, situated on a spacious 651sqm land parcel this property has a spacious floor plan designed for wonderful living and outdoor entertaining.

This Immaculate home is positioned just moments from quality Schools, local shops, beautiful parks, public transport and the M4 Motor Way.

- Functional layout provides distinct spacious living and dining zones
- Wonderful in-ground pool

**Type** : House  
**Land Size** : 651 sqm  
**View** : <https://www.aitkenre.com.au/8060564>



**Joey Lustrì**  
**02 4732 5055**

[For full version visit the website](https://www.aitkenre.com.au)



DISCLAIMER: All dimensions herein are approximate and gathered from sources believed to be reliable. Whilst every effort is made for the accuracy of our plans, interested parties should rely on their own enquiries.

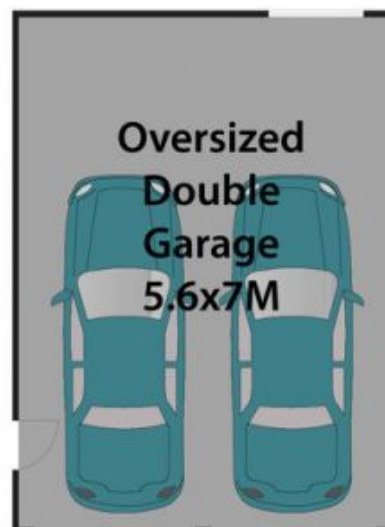
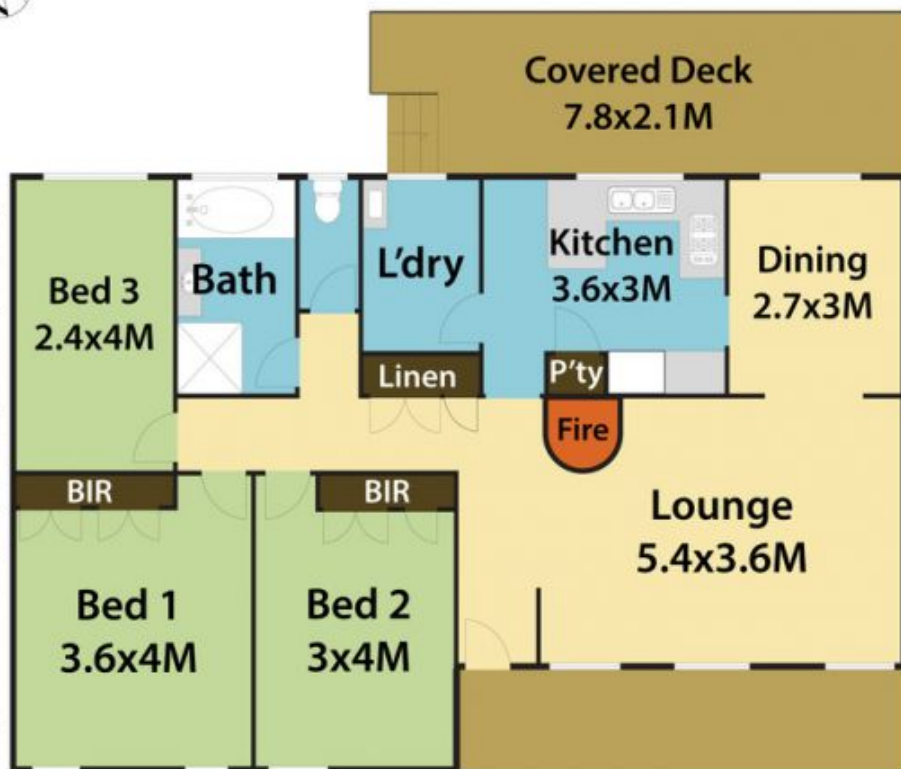

**2 Enfield St, Jamisontown.**

