



20 Matilda Road JORDAN SPRINGS NSW

4  2  1 

Carefully constructed by Adenbrook Homes and Gem Frame and Truss, this incredible 10 month young home offers quality inclusions, an abundance of space and fantastic outdoor entertaining. This homes versatile floor plan is sure to suit the most particular of buyers.

Type : House
Land Size : 330 sqm
View : <https://www.aitkenre.com.au/8060504>

Features include:

- Four good sized bedrooms with ceiling fans, quality carpet and built-ins to all, with the main bedroom having a walk-in robe and ensuite.
- Gorgeous large kitchen complete with island bench, stainless steel appliances, gas cooking, ample cupboard space and stone bench tops.
- Spacious tiled living and dining area.



Joey Lustrini
02 4732 5055

[For full version visit the website](https://www.aitkenre.com.au)

DISCLAIMER: All dimensions herein are approximate and gathered from sources believed to be reliable. Whilst every effort is made for the accuracy of our plans, interested parties should rely on their own enquiries.

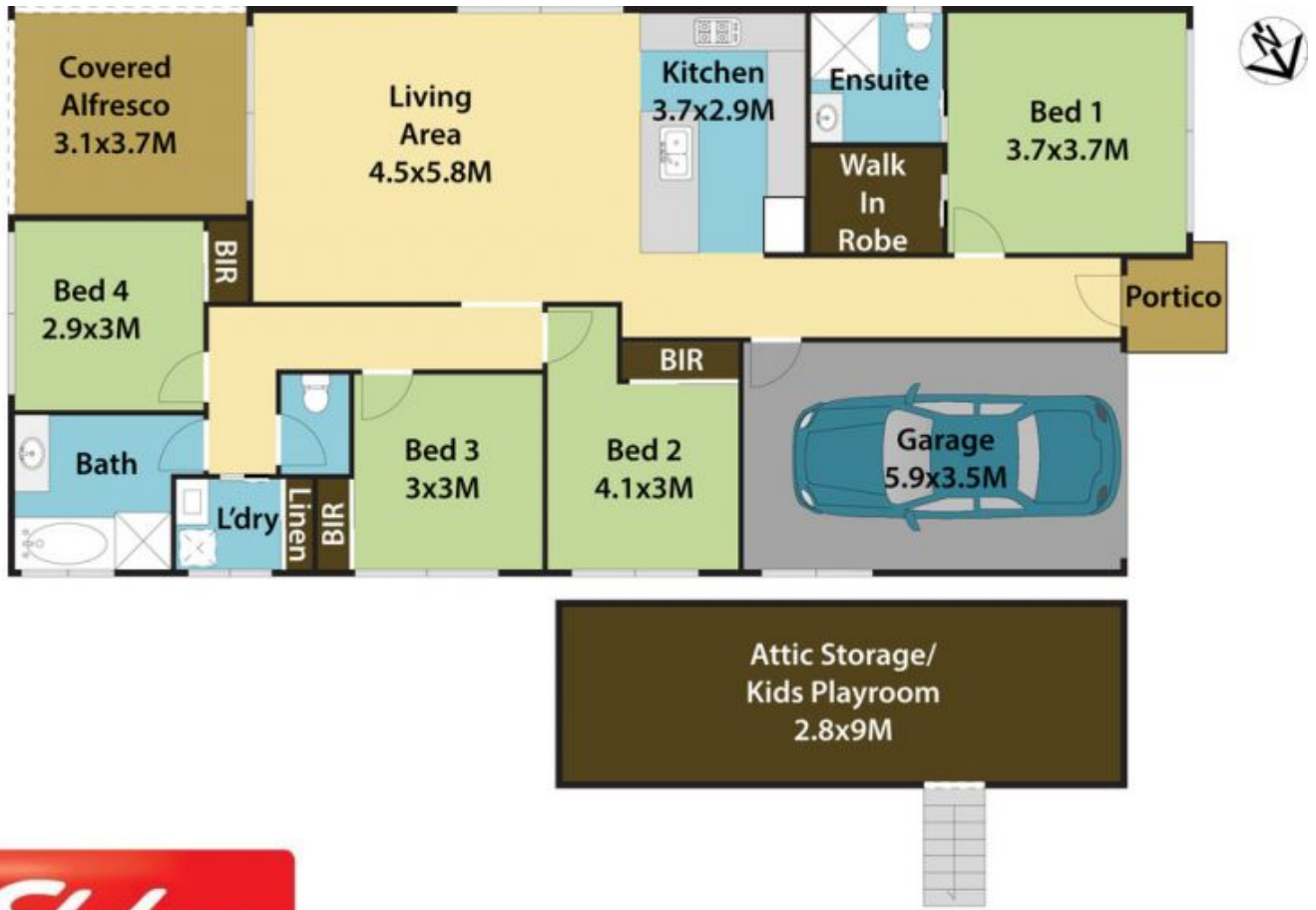

20 Matilda Rd, Jordan Springs.