



**35 Devaney Avenue Glenmore Park NSW**

4  3  4 

This larger than life home in a sought-after location in stage one Glenmore Park is conveniently close to a range of amenities. Shopping centres, schools, parks, and recreational facilities ensuring a convenient and enjoyable lifestyle for the whole family.

**Type** : House  
**Price** : \$ 1,440,000  
**Land Size** : 826 sqm  
**View** : <https://www.aitkenre.com.au/8060397>

- + 10.73kw Solar System with 29 panels
- + Renovated kitchen with 40mm Caesar stone bench tops
- + Ducted air conditioning
- + Multiple living spaces
- + Undercover entertaining overlooking huge pool
- + Double garage with internal access
- + Combustion fireplace

Words do not do this property justice, book your private

[For full version visit the website](#)

Ground floor  
200.2 sq.m. approx.



1st floor  
99.8 sq.m. approx.

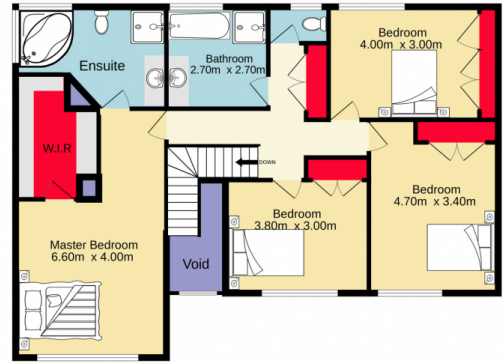

TOTAL FLOOR AREA : 300.0 sq.m. approx.

Whilst every attempt has been made to ensure the accuracy of the floorplan contained here, measurements of doors, windows, rooms and any other items are approximate and no responsibility is taken for any error, omission or mis-statement. This plan is for illustrative purposes only and should be used as such by any prospective purchaser. The services, systems and appliances shown have not been tested and no guarantee as to their operability or efficiency can be given.  
Made with Metropix ©2023