



8 Wiles Place Cambridge Park NSW

3  1  3 

This three bedroom home has the bones to work with for the savvy buyer who isn't afraid on making it their own.

- + Ample off street parking
- + Brick veneer construction
- + Multiple living spaces
- + Enclosed sunroom
- + Whisper quiet cul de sac location
- + 651m2 (approx) block size

Type : House
Price : \$ 695,000
Land Size : 651 sqm
View : <https://www.aitkenre.com.au/8060303>

Located in a private location but still only 10 minutes from the Penrith CBD and close to local schools and shops, book your inspection now as this property won't last.

Recently the NSW State Government announced the ban

[For full version visit the website](#)

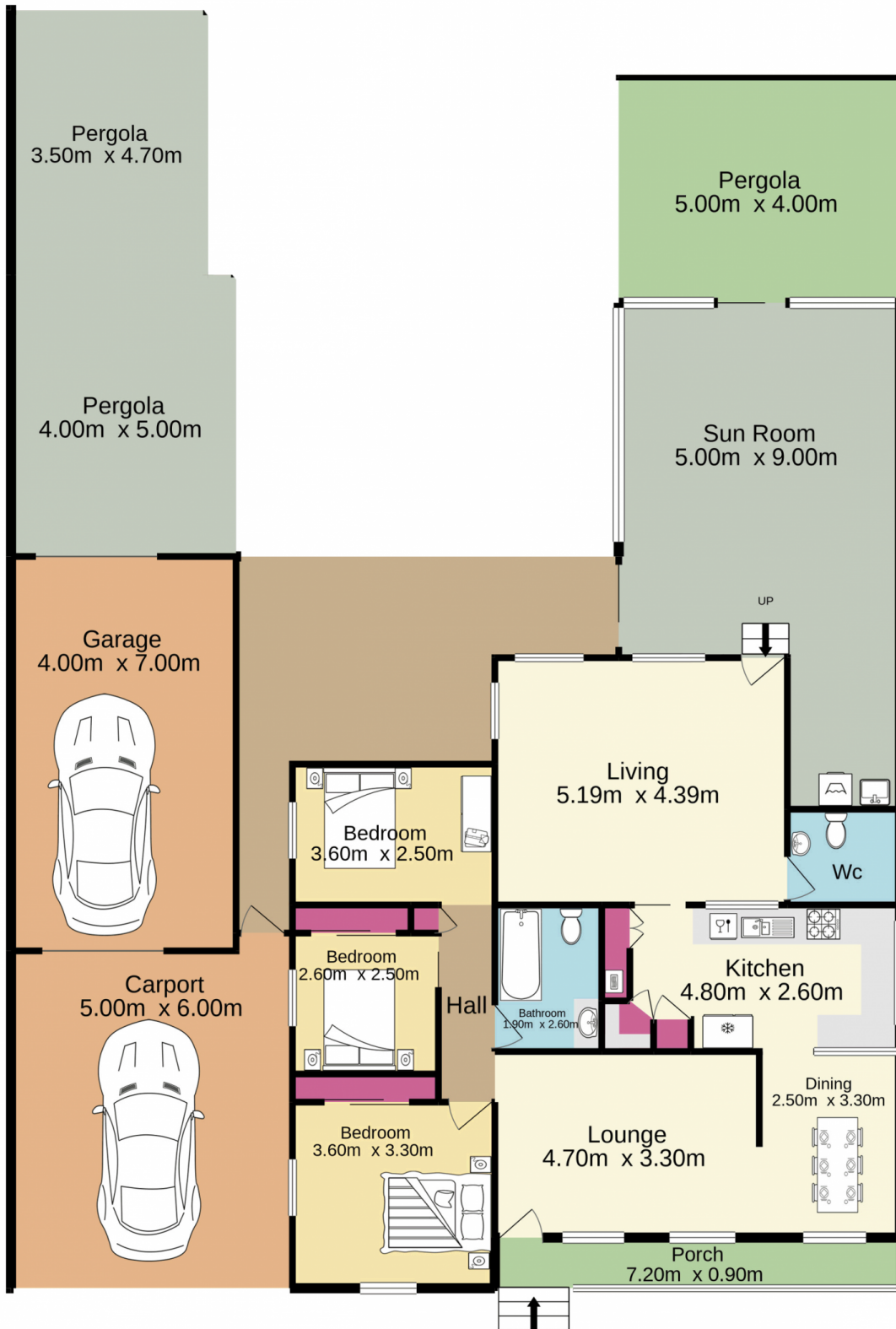

 **Jim Aitken**
Partners

TOTAL FLOOR AREA : 257.6 sq.m. approx.

Whilst every attempt has been made to ensure the accuracy of the floorplan contained here, measurements of doors, windows, rooms and any other items are approximate and no responsibility is taken for any error, omission or mis-statement. This plan is for illustrative purposes only and should be used as such by any prospective purchaser. The services, systems and appliances shown have not been tested and no guarantee as to their operability or efficiency can be given.
Made with Metropix ©2021