

50 Jubilee Drive Jordan Springs NSW

4 2 2

This beautiful family home, set in a tranquil location opposite the peaceful regional natural park, ticks all the boxes.

The cleverly designed plan offers four spacious bedrooms, two convenient bathrooms, two separate living areas & an open plan modern kitchen with stone island bench & stainless steel appliances.

Be the first to view this appealing quality home as it will not last.

Other features include:

- * Ducted air conditioning & alarm
- * Master with ensuite & walk-in robe

Type : House
Price : \$ 685,000
Building Size : 177 sqm
Land Size : 300 sqm
View : <https://www.aitkenre.com.au/8060118>

[For full version visit the website](https://www.aitkenre.com.au)



R&W

Jordan Springs/Werrington County

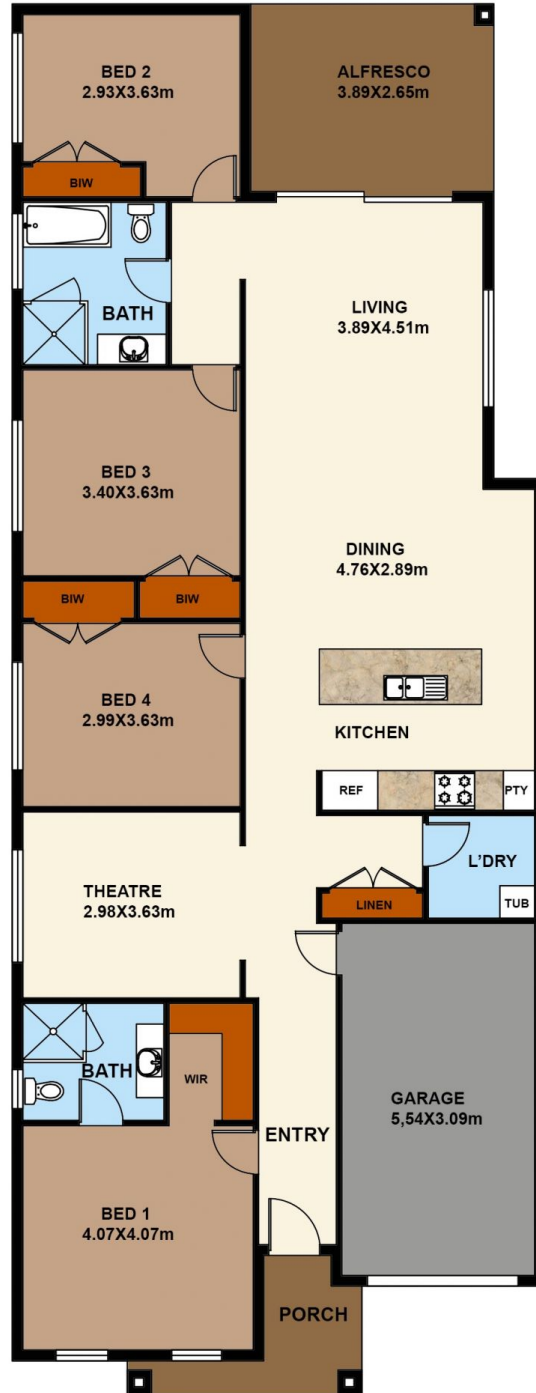

FLOOR PLAN

This floor plan including furniture, fixture measurements and dimensions are approximate and for illustrative purposes only. Boxbrownie.com gives no guarantee, warranty or representation as to the accuracy and layout. All enquiries must be directed to the agent, vendor or party representing this floor plan.

50 Jubilee Drive, Jordan Springs