



**21 Shellbourne Place Cranebrook NSW**

4  2  4 

This property's location is a rare find. Nestled away in a quiet street, this home boasts open living areas and a large master bedroom. All spacious bedrooms fitted with built-in wardrobes, with the master featuring a walk-in wardrobe and ensuite. Free-flowing and meticulously maintained, you will love the easy living arrangement.

**Type** : House  
**Land Size** : 508 sqm  
**View** : <https://www.aitkenre.com.au/8059964>

- \* Split system air conditioning
- \* Open plan living
- \* Natural gas cooking
- \* Built-in wardrobes
- \* Alfresco entertainment area
- \* Less than 5 years old
- \* Double garage

[For full version visit the website](https://www.aitkenre.com.au)

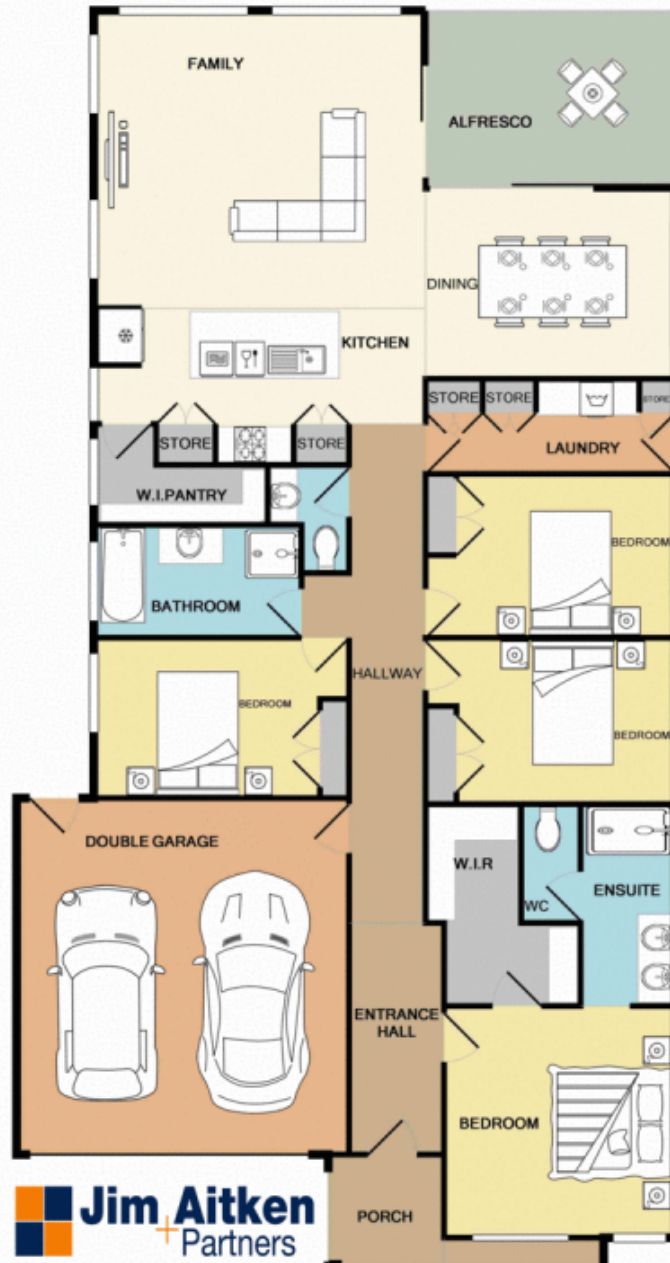

**Jim Aitken**  
Partners

Whilst every attempt has been made to ensure the accuracy of the floor plan contained here, measurements of doors, windows, rooms and any other items are approximate and no responsibility is taken for any error, omission, or mis-statement. This plan is for illustrative purposes only and should be used as such by any prospective purchaser. The services, systems and appliances shown have not been tested and no guarantee as to their operability or efficiency can be given.  
Made with Metropix 62018