





## 25 Murphy Street Blaxland NSW

3  1  1 

Imagine living within a short stroll to a choice of nine dining options, a modern hotel, parks, tennis courts, lagoon, schools and public transport! 25 Murphy St, Blaxland is ideally located, to say the least. This solid brick and tile construction with ornate cornices, sizeable covered front porch to watch the world go by and huge garage and carport space to enjoy hobbies, will suit a multitude of savvy buyers. Especially those with the creativity and desire to update these original features to design the family home of their dreams. Don't delay to book an appointment for your private inspection.

- + Easy walk to shops, restaurants and neighbourhood facilities.
- + Three bedrooms and gorgeous original bathroom

[For full version visit the website](https://www.aitkenre.com.au/8059756)

**Type** : House  
**Land Size** : 531 sqm  
**View** : <https://www.aitkenre.com.au/8059756>



**Kieran Flanagan**  
**02 4739 1111**

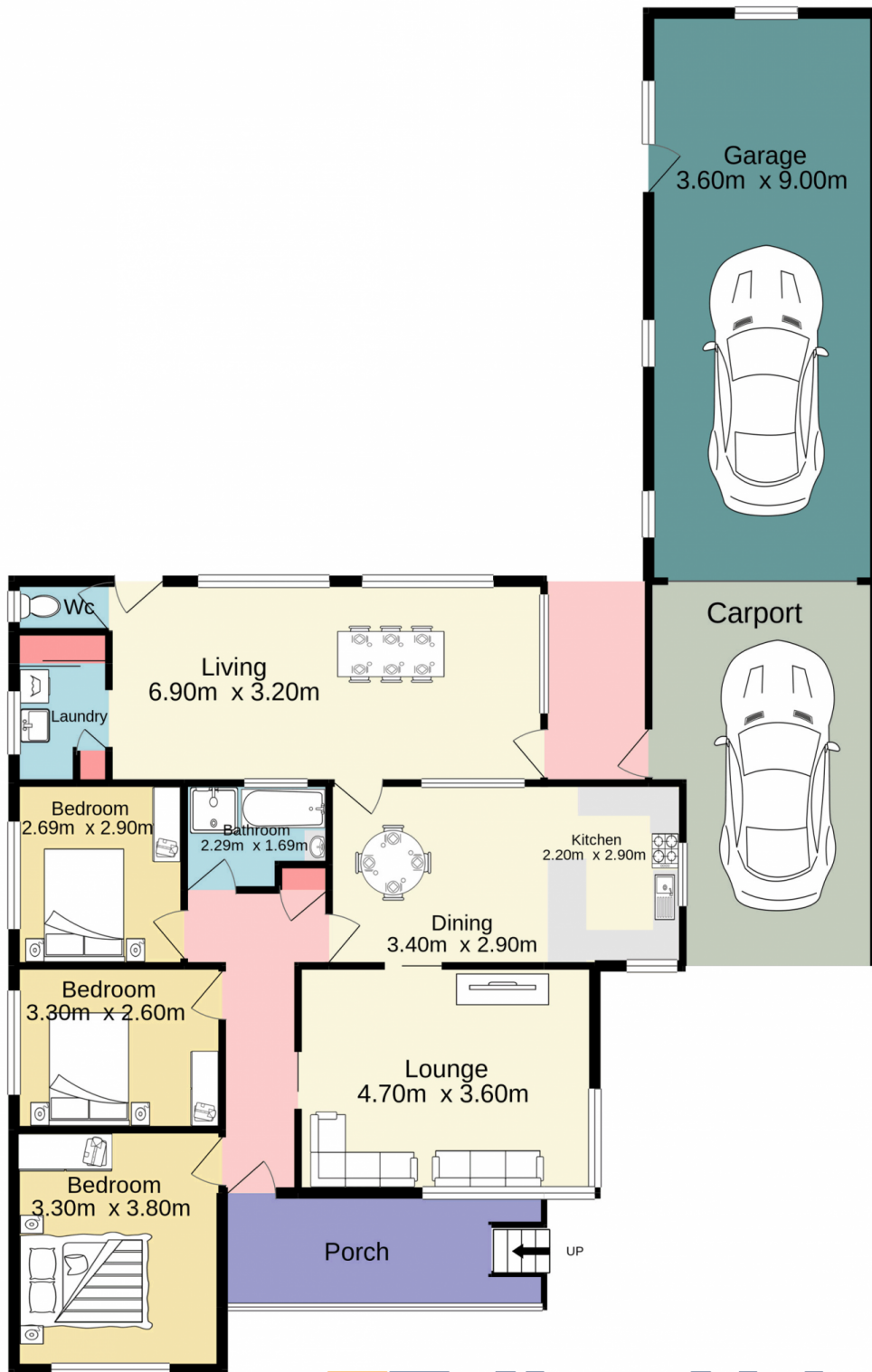

# Jim Aitken Partners



TOTAL FLOOR AREA : 157.9 sq.m. approx.

Whilst every attempt has been made to ensure the accuracy of the floorplan contained here, measurements of doors, windows, rooms and any other items are approximate and no responsibility is taken for any error, omission or mis-statement. This plan is for illustrative purposes only and should be used as such by any prospective purchaser. The services, systems and appliances shown have not been tested and no guarantee as to their operability or efficiency can be given.  
Made with Metropix ©2021