



**99 Buena Vista Road Winmalee NSW**

5 🛏 3 🚿 4 🚗

Wake up every morning looking out over the bush, breathing in the fresh mountains air. This spacious, five bedroom family home, with its functional split level floor plan, maximises the stunning rear views. Your half acre piece of paradise is clear and could easily accommodate a large swimming pool, large garden entertaining area or outbuilding. There are 2 generous covered entertaining areas and even a wine storage room. The flexible floor plan could even accommodate a studio/retreat for teens/in-laws or hobbies.

**Type** : House  
**Building Size** : 200 sqm  
**Land Size** : 2112 sqm  
**View** : <https://www.aitkenre.com.au/8059738>

- + 2112m2 block with large usable areas and stunning bush backdrop
- + Interesting split-level design, maximising views
- + Multiple living areas to suit all family members

[For full version visit the website](https://www.aitkenre.com.au)

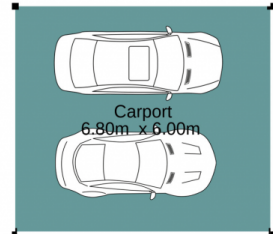
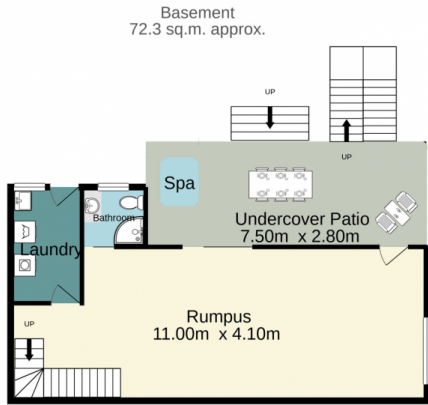

**Jim Aitken**  
Partners

TOTAL FLOOR AREA : 271.6 sq.m. approx.

Whilst every attempt has been made to ensure the accuracy of the floorplan contained here, measurements of doors, windows, rooms and any other items are approximate and no responsibility is taken for any error, omission or mis-statement. This plan is for illustrative purposes only and should be used as such by any prospective purchaser. The services, systems and appliances shown have not been tested and no guarantee as to their operability or efficiency can be given.

Made with Metropix ©2021

