





### 16 Gosling Street Emu Heights NSW

4  3  4 

Nestled in a quiet no-through road, this expansive three-level home offers a versatile floor plan perfect for modern living. With multiple living zones, it provides flexible spaces for relaxation, work, and entertainment.

Choose between two main bedrooms, each with its own ensuite, and enjoy the comfort of ducted air conditioning throughout. The home also features a dedicated work-from-home hub, a parents' retreat, and a hobby room.

Surrounded by a leafy aspect, this home is an ideal sanctuary for growing families seeking space and privacy.

DISCLAIMER: Whilst we deem this information to be

[For full version visit the website](https://www.aitkenre.com.au)

**Type** : House  
**Price** : \$1,195,000 - \$1,265,000  
**Land Size** : 668 sqm  
**View** : <https://www.aitkenre.com.au/8058968>



**David Reeves**  
02 4735 2121



**Andrew Lia**  
02 4735 2121

Ground floor  
153.4 sq.m. approx.

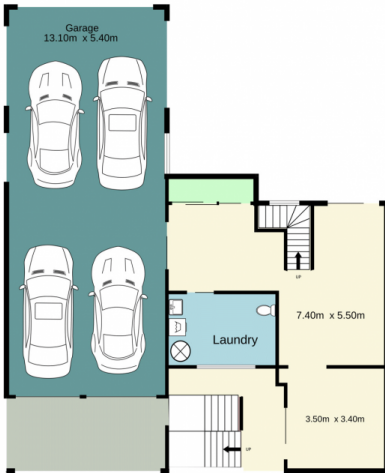

Entrance floor  
139.2 sq.m. approx.



1st floor  
62.7 sq.m. approx.



TOTAL FLOOR AREA : 355.2 sq.m. approx.

Whilst every attempt has been made to ensure the accuracy of the floorplan contained here, measurements of doors, windows, rooms and any other items are approximate and no responsibility is taken for any error, omission or mis-statement. This plan is for illustrative purposes only and should be used as such by any prospective purchaser. The services, systems and appliances shown have not been tested and no guarantee as to their operability or efficiency can be given.  
Made with Metropix ©2024

