



## 21 Liddle Street North St Marys NSW

3  1 

Experience the charm of the past with a home that offers a window into the suburbs' rich history! Nestled amidst a tapestry of architectural wonders from yesteryears, this residence eagerly awaits restoration to its former glory, offering you a canvas to paint your dreams upon.

In conjunction with support from Penrith Council, this historical gem now boasts a brand-new roof, ensuring peace of mind for the discerning buyer. Imagine the possibilities as you envision yourself as the steward of this timeless beauty, preserving its heritage while infusing modern comforts.

Overlooking a serene public recreation space, tranquility and greenery greet you at every turn, providing a refreshing

**Type** : House  
**Land Size** : 537 sqm  
**View** : <https://www.aitkenre.com.au/8058805>



**David Reeves**  
02 4735 2121



**Robert Rolls**  
02 4732 5055

[For full version visit the website](https://www.aitkenre.com.au)



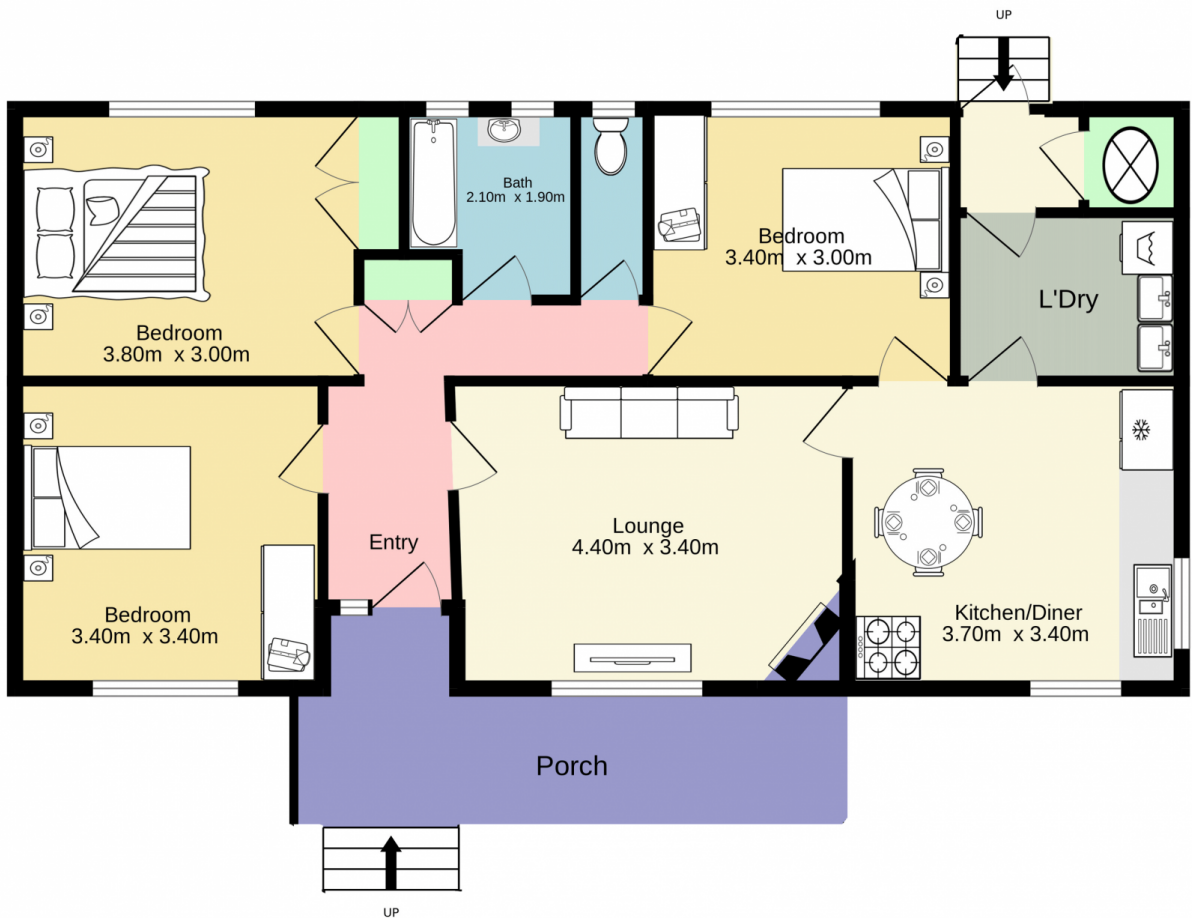

**Jim Aitken**  
Partners



TOTAL FLOOR AREA : 81.4 sq.m. approx.

Whilst every attempt has been made to ensure the accuracy of the floorplan contained here, measurements of doors, windows, rooms and any other items are approximate and no responsibility is taken for any error, omission or mis-statement. This plan is for illustrative purposes only and should be used as such by any prospective purchaser. The services, systems and appliances shown have not been tested and no guarantee as to their operability or efficiency can be given.  
Made with Metropix ©2024