



4 Tall Trees Drive Glenmore Park NSW

4 🏠 2 🚗 4 🚗

Welcome to your modern sanctuary nestled within this highly desirable estate. This impeccable home boasts an array of state-of-the-art technology, enhancing your everyday living experience.

Step inside to discover a contemporary open-plan layout that seamlessly integrates the living, dining, and kitchen areas, creating a spacious and inviting environment for relaxation and entertaining alike.

Embrace the ease and convenience of 'Smart Home' controlled lighting, ensuring the perfect ambiance for any occasion with just a simple touch. The same system ensures year-round comfort with individual temperature control for the air conditioning.

Type : House
Land Size : 477 sqm
View : <https://www.aitkenre.com.au/8058791>



David Reeves
02 4735 2121

[For full version visit the website](https://www.aitkenre.com.au)

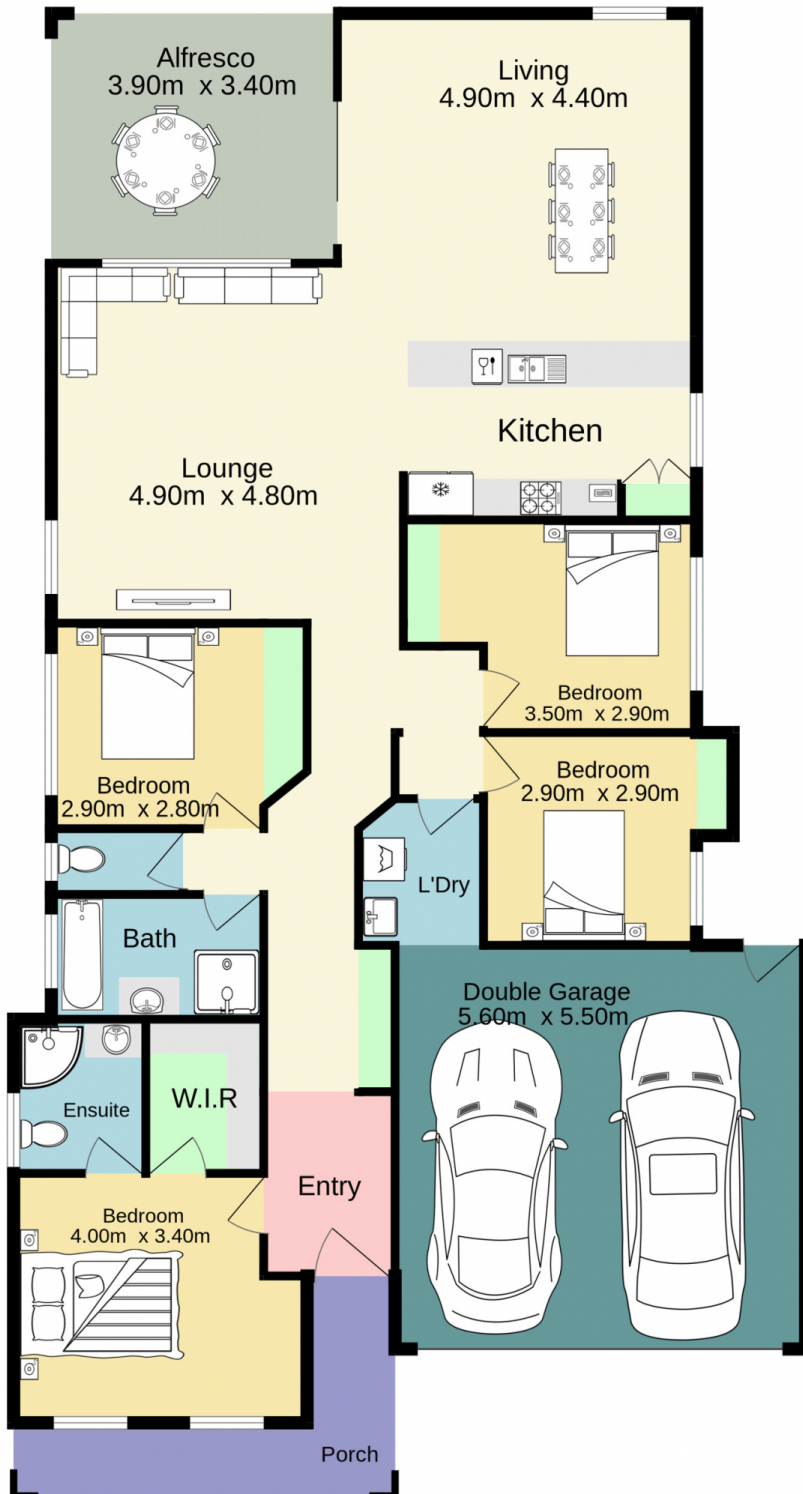

Jim Aitken
Partners



TOTAL FLOOR AREA : 174.1 sq.m. approx.

Whilst every attempt has been made to ensure the accuracy of the floorplan contained here, measurements of doors, windows, rooms and any other items are approximate and no responsibility is taken for any error, omission or mis-statement. This plan is for illustrative purposes only and should be used as such by any prospective purchaser. The services, systems and appliances shown have not been tested and no guarantee as to their operability or efficiency can be given.
Made with Metropix ©2024