



19 Southee Road Hobartville NSW

3  1 

Spring to action and jump on this exciting opportunity! Ideally located close to what counts, you'll just love the convenience.

- + Timber floors
- + Split system air conditioning
- + Large detached storage shed
- + Side access to rear yard
- + Approx 2km to Richmond town centre
- + Approx 1km to Western Sydney University (Hawkesbury)
- + Approx 700m to Public School

DISCLAIMER: Whilst we deem this information to be reliable the agent cannot guarantee its accuracy and accepts no responsibility for such. Interested persons

Type : House
Land Size : 556 sqm
View : <https://www.aitkenre.com.au/8058777>



David Reeves
02 4735 2121



Robert Rolls
02 4732 5055

[For full version visit the website](https://www.aitkenre.com.au)

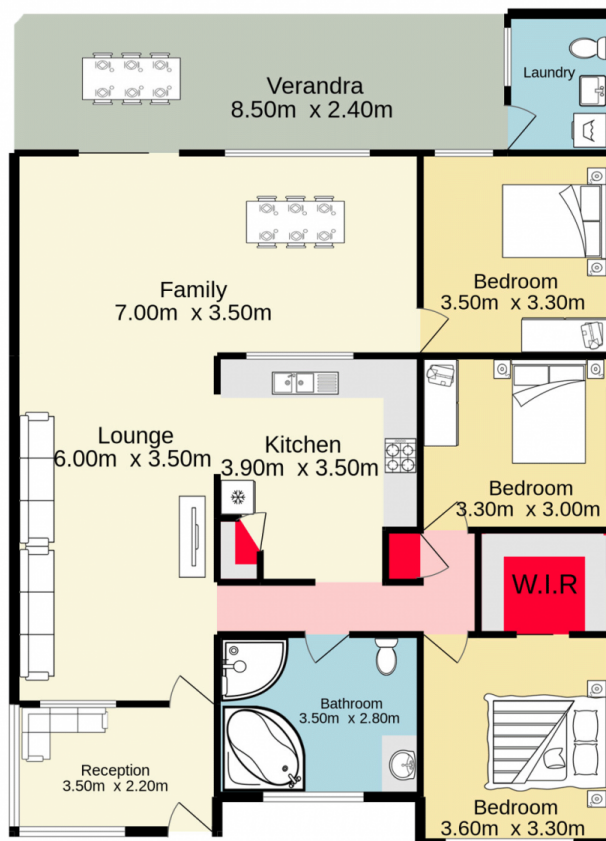
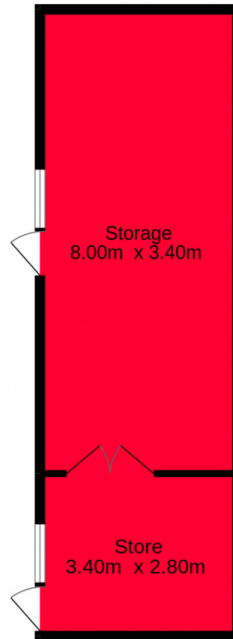

TOTAL FLOOR AREA : 180.4 sq.m. approx.

Whilst every attempt has been made to ensure the accuracy of the floorplan contained here, measurements of doors, windows, rooms and any other items are approximate and no responsibility is taken for any error, omission or mis-statement. This plan is for illustrative purposes only and should be used as such by any prospective purchaser. The services, systems and appliances shown have not been tested and no guarantee as to their operability or efficiency can be given.
Made with Metropix ©2022