



8 Panorama Avenue Leonay NSW

4 3 4

Located in the heart of Leonay you'll love the position that's only a short walk to Wiggles and Giggles day care, Willowtree caf and New Dimensions Gym. The property is expansive, contains multiple living spaces and an in ground pool with plenty of yard left over.

- + Spacious master bedroom with ensuite bathroom
- + Three large living rooms
- + The comfort of ducted air conditioning
- + Clever under house storage
- + Covered entertaining areas
- + Outdoor pool bathroom
- + Less than 500 meters to Leonay Primary School

You can inspect our properties at both open homes and by

[For full version visit the website](https://www.aitkenre.com.au)

Type : House
Price : \$ 1,030,000
Land Size : 841 sqm
View : <https://www.aitkenre.com.au/8058773>



David Reeves
02 4735 2121



Andrew Lia
02 4735 2121

GROUND FLOOR
135.9 sq.m. approx.

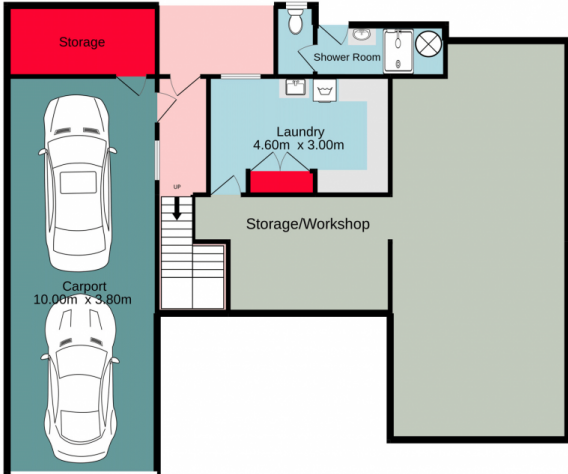

ENTRANCE FLOOR
184.5 sq.m. approx.



TOTAL FLOOR AREA : 320.4 sq.m. approx.

Whilst every attempt has been made to ensure the accuracy of the floorplan contained here, measurements of doors, windows, rooms and any other items are approximate and no responsibility is taken for any error, omission or mis-statement. This plan is for illustrative purposes only and should be used as such by any prospective purchaser. The services, systems and appliances shown have not been tested and no guarantee as to their operability or efficiency can be given.
Made with Metropix ©2022